

# SUMMARY REPORT

University of Illinois  
**HERITAGE**  
MASTER PLAN

Division of Intercollegiate Athletics



University of Illinois

# Heritage Master Plan

Division of Intercollegiate Athletics

## Conceptual Master Plan for the Athletic Campus including Interpretive Elements, Site Development and Architecture

May 22, 2001

Prepared For:



Division of Intercollegiate Athletics  
University of Illinois at Urbana-Champaign

Prepared By:



**Isaksen-Glerum PC Architects**

ARCHITECTURE • PLANNING • INTERIOR DESIGN  
114 WEST MAIN STREET URBANA, ILLINOIS TEL (217)328-1391 FAX (217)328-1401

**SmithGroup JJR**

Planning & Landscape Architecture  
30 W. MONROE ST., SUITE 1010  
CHICAGO, ILLINOIS 60603  
TEL (312)641-6756 FAX (312)641-6728

The logo is a stylized, handwritten-style signature of the word 'Hilferty' in a dark grey or black color.

**Gerard Hilferty & Associates, Inc.**  
*Interpretive Planning and Design*

14240 ROUTE 550  
ATHENS, OHIO 45701  
TEL (740)448-3821 FAX (740) 448-2331



## Acknowledgements

### University of Illinois

#### DIVISION OF INTERCOLLEGIATE ATHLETICS

Ron Guenther, Athletic Director  
Terry Cole, Assistant Athletic Director  
Tom Porter, Assistant Athletic Director  
Dana Brenner, Assistant Athletic Director  
Sally Ross, Assistant Athletic Director/Academic Services  
Kent Brown, Assistant Athletic Director/Sports Information Director  
Dick Barnes, Assistant Sports Information Director  
Terry Hayden, Assistant Sports Information Director

#### OFFICE OF PROJECT PLANNING AND FACILITY MANAGEMENT

Roland Kehe, Campus Architect  
Kevin Duff, Campus Landscape Architect

### Sports Publishing

Mike Pearson, Vice President of Acquisitions

### Isaksen Glerum PC Architects

Riley Glerum, Principal  
Scot Wachter, Senior Planner/Designer  
Julie Folsom, Executive Assistant

### SmithGroup JJR

Paul Wiese, Principal  
Randy Machelski, Senior Planner/Designer  
Neal Kessler, Senior Planner/Designer

### Gerard Hilferty and Associates, Inc.

Skip Rhodes, Principal  
Tim Pfaff, Developer  
Kjirsten Malmberg-Janes, Associate



Isaksen-Glerum

SmithGroup JJR



## Table of Contents

### Executive Summary

Introduction, Project Vision and Interpretive Highlights .....	1
Master Plan - Athletic Campus .....	4
Aerial View of the Athletic Campus from Northwest .....	5
Aerial View of the Athletic Campus from East .....	6

### Mission, Vision and Audience

Mission, Vision and Audience Statement .....	7
Visitor Flow Diagrams .....	11

### Site/Building Program and Master Plan

Master Plan Approach .....	12
Site and Building Program .....	14
Keyed Master Plan - Athletic Campus .....	21
Enlarged Master Plan - Athletic Campus .....	22

### Interpretive Concepts

Multi-Sport Complex .....	23
Visitor Center Gallery Sketch .....	26
Illini Park .....	27
Bielfeldt Athletic Administration Building .....	29
Bielfeldt Sketch .....	31
Ubben-Bielfeldt Courtyard and Pedestrian Spine .....	32
Ubben Interpretive Courtyard Sketch .....	34
Atkins Tennis Center and East Athletic Campus Entry .....	35
Ubben Basketball Practice Facility .....	36
Assembly Hall/IMPE Indoor Pool/Huff Hall/Armory .....	37
Memorial Stadium .....	39
Irwin Football Practice Facility .....	41
Irwin Academic Center .....	42

### Preliminary Development Budget

Opinion of Interpretive, Site and Building Project Costs .....	43
--	----





## Executive Summary

### Introduction

In September 2000, the University of Illinois Division of Intercollegiate Athletics (DIA) assembled a Design Team of architects and interpretive designers from Isaksen Glerum, SmithGroup JJR, and Gerard Hilferty and Associates to craft a Heritage Master Plan for the University of Illinois Athletic Campus. DIA Athletic Director Ron Guenther challenged the team to develop a plan that would visually unify the Athletic Campus, interpret the rich tradition and storied history of Fighting Illini athletics, and generate excitement among campus visitors.

The Design Team met monthly from September 2000 to May 2001 to assess current Athletic Campus venues, evaluate visitor approach sequences and wayfinding, review existing artifactual and archival resources, and meet with DIA staff and stakeholders to elicit their visions and plans for the future. All existing and proposed buildings were analyzed relative to their continuing role within the Athletic Campus and their contribution to the Heritage Master Plan. Issues addressed in this analysis included current athletic trends, architectural image, functional suitability, operational efficiency, user convenience, flexibility, and historical significance. DIA staff identified a number of needed projects in the long-range building construction program ranging from minor interior remodeling and expansion of existing buildings to new state-of-the-art athletic facilities.

### Project Vision

*The new University of Illinois Athletic Campus will become a unique expression of the Fighting Illini spirit, inviting all visitors to enjoy and become a part of the Illinois tradition.*

As a charter member of the prestigious Big Ten Conference, the University of Illinois is justly proud of a storied athletic tradition reaching back more than a century. Illini teams have earned more than 200 Big Ten titles in fencing, track and field, baseball, gymnastics, wrestling, football, tennis, golf, swimming, volleyball, and basketball. Illini student athletes have captured national championships and advanced to Olympic glory, professional competition, and successful careers in every sector of society.

In collaboration with DIA, the Design Team developed the following goals for transforming the University of Illinois Athletic Campus.



*The New University of Illinois Athletic Campus will...*

*...become a unique environment that elicits a strong, positive emotional reaction;*  
*...enhance the Illini fan experience by offering an exciting and fun destination for alumni,*  
*students, faculty, tourists, youth and senior citizens groups, and community members;*  
*...contribute significantly to the recruitment of prospective Illini student athletes;*  
*...stimulate the Fighting Illini Scholarship Fund and capital project donor activity;*  
*...provide recreational opportunities for campus and community residents through creative*  
*landscaping;*  
*...maintain settings suitable for hosting a wide range of functions and groups;*  
*...develop a proper facility for the storage, preservation, and display of historic archival*  
*and artifactual materials;*  
*...and, create flexible exhibits with an eye toward future growth.*

### **Interpretive Highlights**

Visitors to the Athletic Campus will know immediately that they have arrived at a place of stature, built on the rich tradition and spirit of the Fighting Illini and the State of Illinois, very much engaged in the prospects for an exciting, dynamic future. Unifying architectural design motifs, landscape features, and interpretive exhibits will guide visitors intuitively throughout the Campus. They will communicate messages of quality, integrity, vitality, and fun that have so long characterized Illini sports.

Sculptural gateways, interpretive landscaping elements, and a unified wayfinding system will welcome visitors and encourage a much more intuitive flow throughout the Athletic Campus. Illini Park, at the intersection of Fourth and Florida, becomes a major new orientation space for visitors, uniting the historic venues located along Fourth Street with the more contemporary venues south of Florida Avenue. Framed by Assembly Hall and Memorial Stadium to the west, Bielfeldt Administration to the south, and a new Multi-Sport Practice and Competition Arena to the East, Illini Park includes a stunning new water feature, playful sculpture, colorful banners, and other interpretive elements that tell visitors they have arrived at the home of the Fighting Illini.





Interior interpretation at Bielfeldt and a new Visitors Center inside the Multi-Sport Complex offer visitor amenities, physical orientation to campus offerings, and two dramatic audiovisual experiences that present “Who we are and what we aspire to become.”

A preliminary program of requirements was developed for the Multi-Sport Complex as a part of this study. A high priority project, the building will include practice areas and a competition arena for volleyball, wrestling and gymnastics. In addition, strength and conditioning, sports medicine, lockers and equipment management facilities will be centralized and consolidated here. The Athletic Campus Visitors Center and a satellite ticket office will also be included.

From Illini Park, visitors follow a central pedestrian spine connecting Bielfeldt Administration and Atkins Tennis Center. Landscape features and architectural gateways enhance the visitors’ sense of arrival at each competition venue along the way. Playful sculptures, graphic panels, and interactive elements invite visitors to enjoy the outdoor spaces while making connections with Illini Hall of Famers. At the eastern terminus of the pedestrian spine, Atkins Tennis Center is expanded with new stadium courts, parking facilities, visitor amenities, and interpretive elements that position the University of Illinois to host major tournaments such as the NCAA Championships.

Interpretation at each of the competition venues is layered and flexible. Outstanding student athletes and coaches, major championships and awards, and stellar performances are accented with sculpture, audiovisual/theatrical presentations, colorful graphics, and exhibited artifacts. Computer touchscreen systems enable visitors to look up Illini letter-winners and retrieve statistical information. Interactives engage visitors in the movements and challenges of sport and invite visitors to test themselves against Illini greats.

Visitors will come to appreciate the University of Illinois’ long-standing commitment to the total individual, and will gain a richer understanding of the power of sport to bring together and unite people of diverse backgrounds in pursuit of common goals, ideals, and loyalties. The new campus will be fun. The new campus will be unique. The new campus will, like Fighting Illini student athletes, aspire to greatness.





Master Plan - Athletic Campus

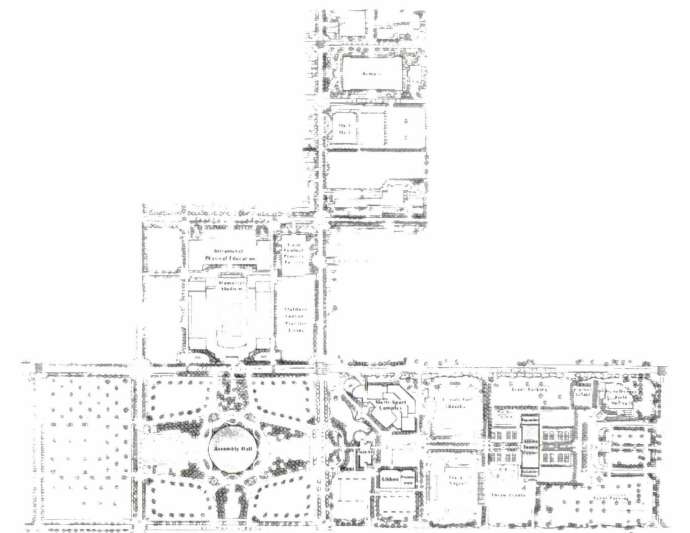
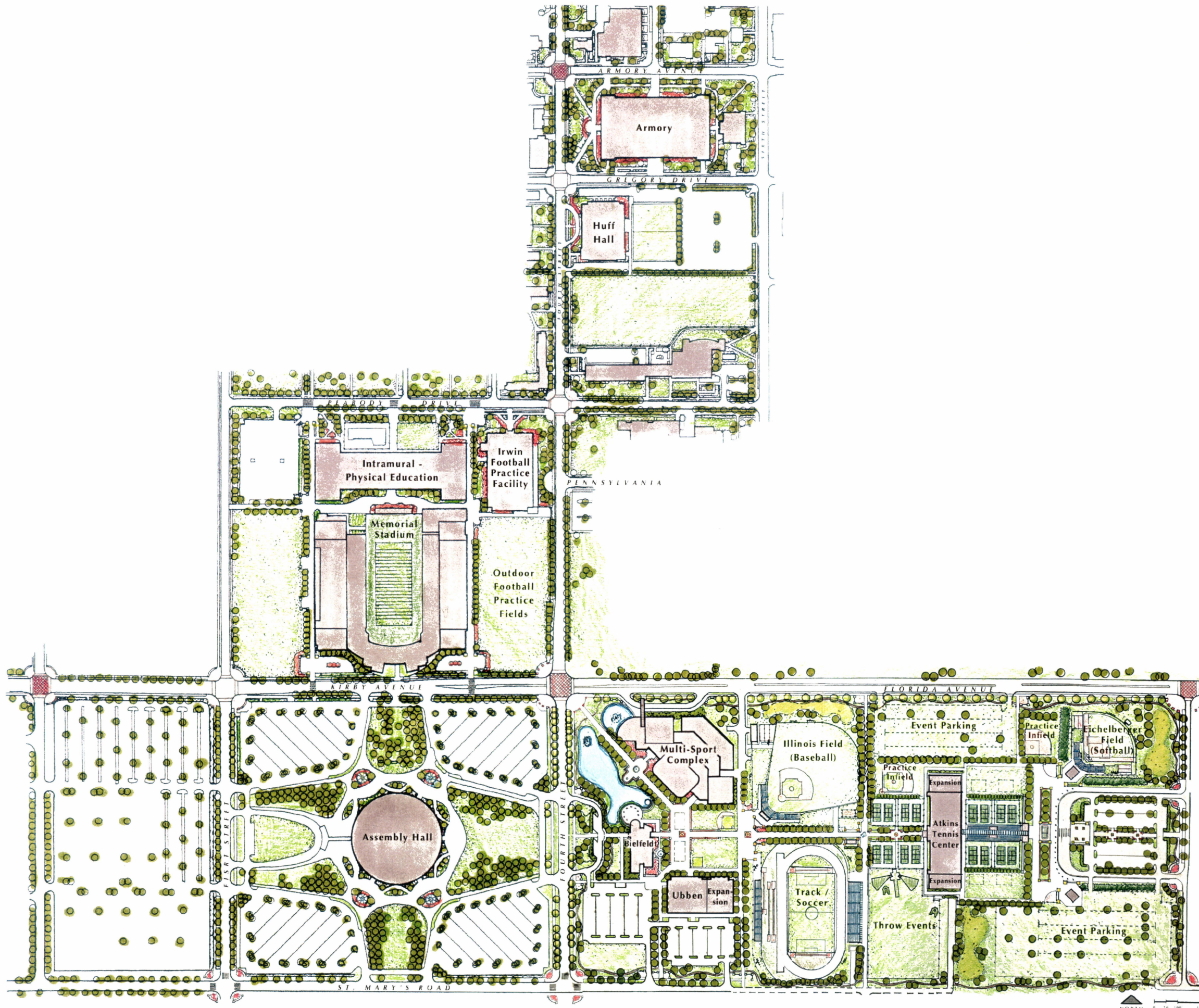



View of Athletic Campus from Northwest





View of Athletic Campus from East





# SUMMARY REPORT

*Articulate and celebrate the rich  
and proud history tradition, and  
spirit of intercollegiate athletics  
at the University of Illinois.*

# MISSION

VISION AND AUDIENCE

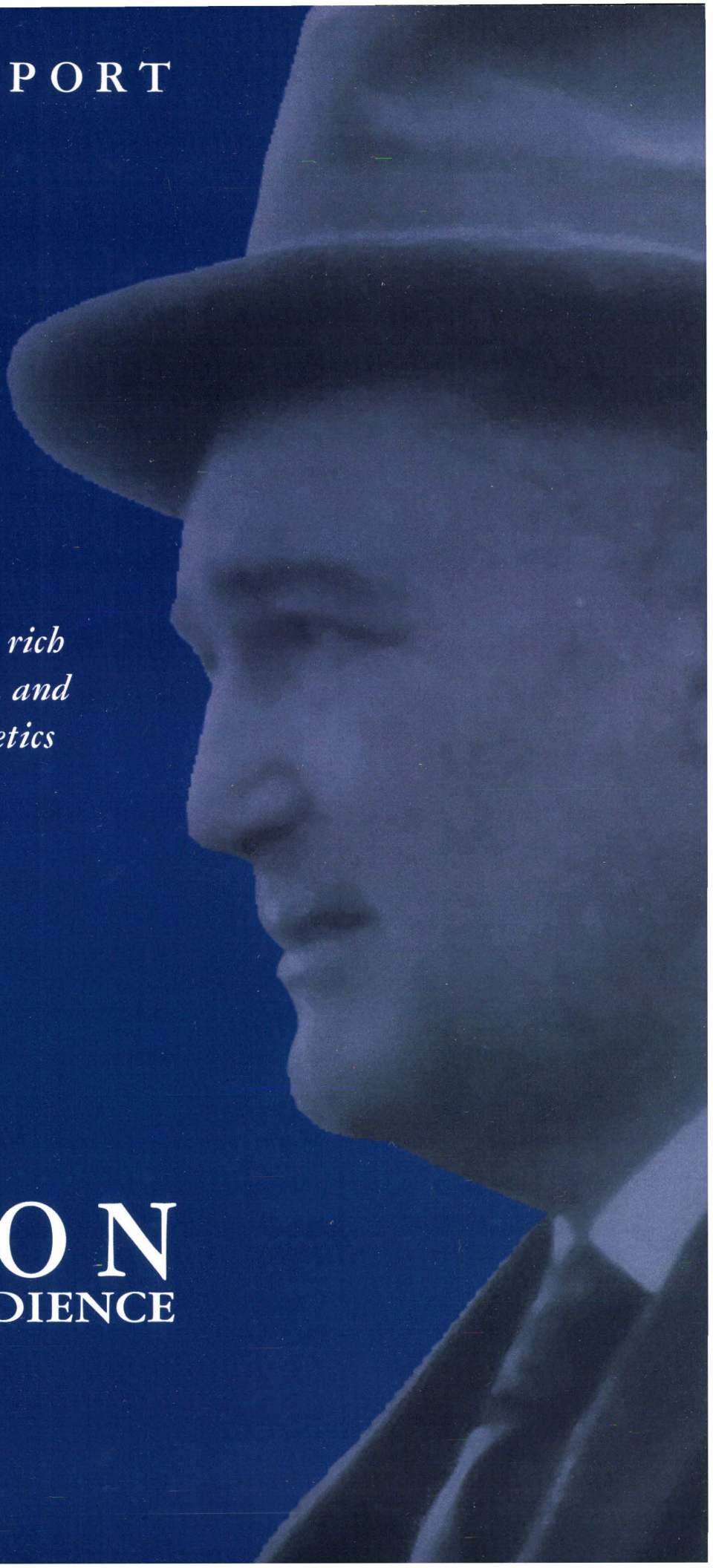



## Mission, Vision, and Audience

### Mission

*Articulate and celebrate the rich and proud history, tradition, and spirit of intercollegiate athletics at the University of Illinois.*

The University of Illinois Department of Intercollegiate Athletics (DIA) exists to produce the highest quality athletic program in all sports, enabling Fighting Illini teams to compete for championships in the Big Ten and the National Collegiate Athletic Association. The DIA measures excellence in terms of integrity, academic performance, balanced budget, championship program, gender and ethnic equity, facilities, and a caring community.

In September 2000, the DIA assembled a Design Team of architects and interpretive designers from Isaksen Glerum, SmithGroup JJR, and Gerard Hilferty and Associates to craft a Heritage Master Plan for the University of Illinois Athletic Campus. The Plan builds on earlier studies, the most recent in 1996 by Donovan J. Kindle that articulated the concept of Illini Park. Kindle cited the DIA's desire to create a warm and friendly atmosphere with unique, inspirational, delightful, and exciting spaces that projected an image of integrity, confidence and joy, and paid due regard to past, present and future ideals.

In collaboration with DIA, the Design Team developed the following goals for transforming the University of Illinois Athletic Campus.

*The University of Illinois Athletic Campus will...*

*...become a unique environment that elicits a strong, positive emotional reaction from visitors;*

*...enhance the Illini fan experience by offering an exciting and fun destination for alumni, students, faculty, tourists, youth and senior citizens groups, and community members;*

*...contribute significantly to the recruitment of prospective Illini student-athletes;*

*...stimulate the Fighting Illini Scholarship Fund and capital project donor activity;*

*...provide recreational opportunities for campus and community residents through creative landscaping;*

*...maintain settings suitable for hosting a wide range of functions and groups;*



*...develop a proper facility for the storage, preservation, and display of historic archival and artifactual materials;*  
*...and, create flexible exhibits with an eye toward future growth.*

## **Scope for the Project**

The scope of this Heritage Master Plan includes the following venues on the University of Illinois Athletic Campus:

- Multi-Sport Complex (Planned)
- Bielfeldt Athletic Administration Building
- Atkins Tennis Center
- Outdoor Track and Soccer Fields
- Ubben Basketball Practice Facility
- Illinois Field (Baseball)
- Eichelberger Field (Softball)
- Memorial Stadium
- Irwin Football Practice Facility
- Assembly Hall
- IMPE Indoor Pool
- Huff Hall, Armory
- Irwin Academic Center

## **Vision**

As a charter member of the prestigious Big Ten Conference, the University of Illinois is justly proud of a storied athletic tradition reaching back more than a century. Illini teams have earned more than 200 Big Ten titles in fencing, track and field, baseball, gymnastics, wrestling, football, tennis, golf, swimming, volleyball, and basketball. Illini student athletes have captured national championships and advanced to Olympic glory, professional competition, and successful careers in every sector of society.

Visitors to the UI Athletic Campus will know immediately that they have arrived at a place of stature, built on the rich tradition and spirit of the Fighting Illini and the State of Illinois, very much engaged in the prospects for an exciting, dynamic future.



Unifying architectural design motifs, landscape features, and interpretive exhibits will guide visitors intuitively throughout the Campus. They will communicate messages of quality, integrity, vitality, and fun that have so long characterized Illini sports.

Illini Park, a central park-like space at the intersection of Kirby and Fourth, will serve as a visual focus to the Campus and the main introduction and orientation point of visitors. The Park will visually link major existing and planned facilities while offering the most opportune starting point for Athletic Campus walking tours and jogging trails. Illini Park will be framed by the existing Bielfeldt Administration Building and a planned new multi-sport practice facility including a competition arena and athletic visitors' center.

The town square, iconic of so many Midwestern communities, offers inspiration for Illini Park. It is a welcoming space, easily accessed by campus residents and community visitors. Illini Park theming speaks to the essence of the student athlete experience at the University of Illinois, combining the energy and daring of youth, the beauty and playfulness of athletic movement, and the values of integrity and academic excellence. Visitors will delight in the spirit of Illini sports and find places for themselves as participants and fans.

Illini Park will offer amenities for outdoor and indoor gatherings. Visitor functions will include physical orientation to the University Campus, with special emphasis on the Athletic Campus, and thematic orientation to the story of Fighting Illini student athletics. Whatever intellectual baggage visitors bring into the exhilarating Visitor Center Orientation Experience will be quickly swept away as visitors are transported to Rose Bowls, Olympic performances, and Big Ten championship finishes. Visitors will meet Illini stars who became legends of their eras, and student-athletes who enjoyed brilliant if sometimes unexpected moments in the sun.

Connecting spokes from Illini Park will lead visitors to all sports venues. Atkins Tennis Center, expanded to the east with new stadium court and parking facilities, will become an enhanced Eastern door to the Athletic Campus. Historic athletic venues such as Memorial Stadium, Assembly Hall, Huff Hall, and the Armory become artifacts for exploring the thrilling moments and heroic performances that took place and continue to unfold within them. Interpretation along walkways connecting these facilities is historical, inspirational, and engaging - celebrating outstanding achievements, honoring noteworthy student athletes, coaches, and friends, and challenging visitors to test themselves against Illini greats through interactive play elements.





The new UI Athletic Campus will be a unique expression of the Fighting Illini spirit, offering all visitors opportunities to enjoy and become a part of the Illinois tradition. Visitors will come to appreciate the University of Illinois' long-standing commitment to the total individual, and will gain a richer understanding of the power of sport to bring together and unite people of diverse backgrounds in pursuit of common goals, ideals, and loyalties. The new campus will be fun. The new campus will be unique. The new campus will, like Fighting Illini student athletes, aspire to greatness.

### **Audience**

The UI Athletic Campus welcomes all visitors. New interpretation will place a special emphasis on communicating the possibilities to potential student athletes. Illini alumni will find opportunities to reminisce and rekindle old friendships while gaining renewed confidence in the prospects for the future. Current students, faculty, and administrators will make daily use of new walking and jogging trails, or simply enjoy the beautiful setting of Illini Park as a comfortable place to relax and pass an afternoon.

Community residents will find increased opportunities for training, workshops, and other public gatherings in a playful environment of interior and exterior spaces. Illini fans will have their enjoyment of the games enhanced by interpretation in and around each venue.





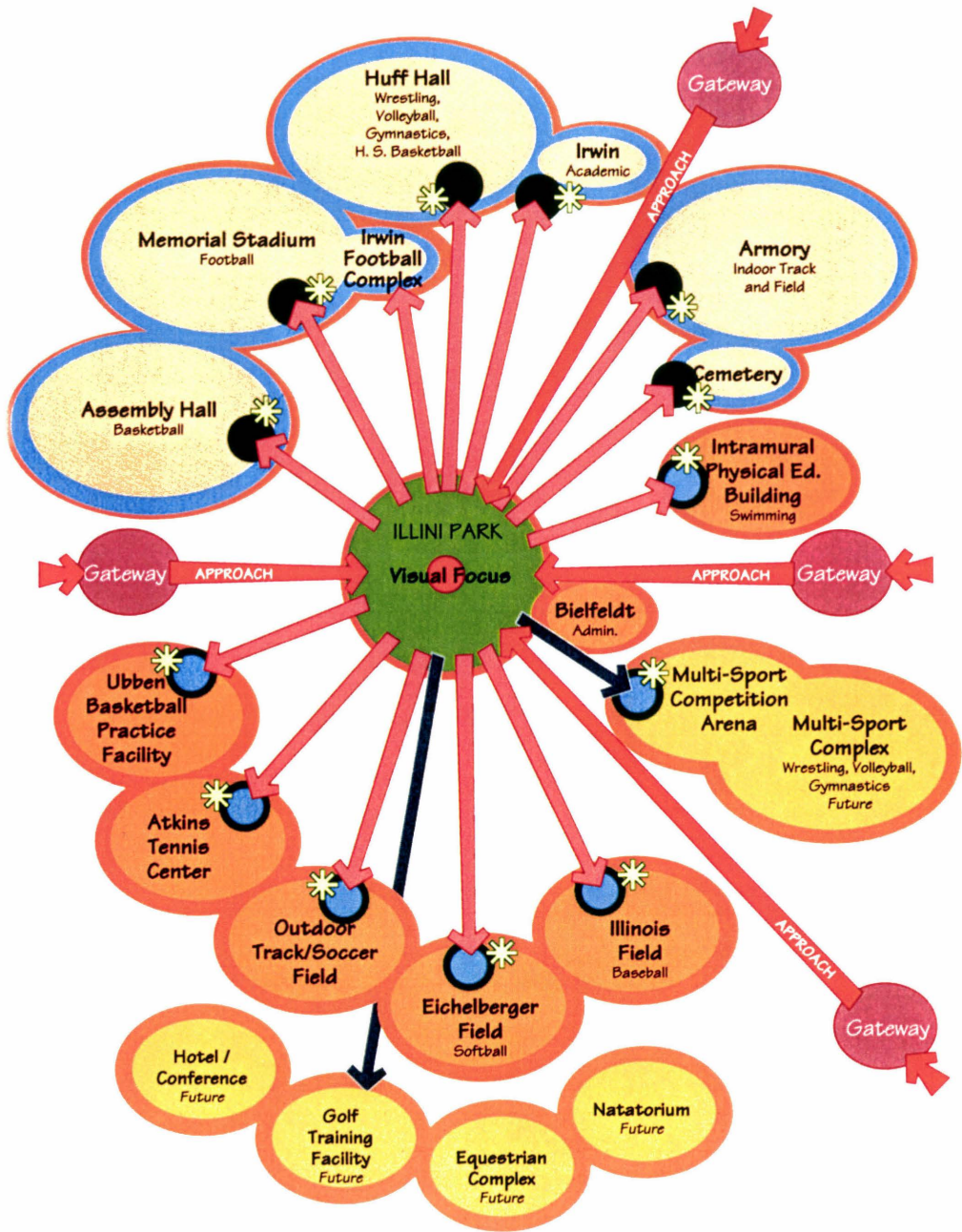

Athletic Campus

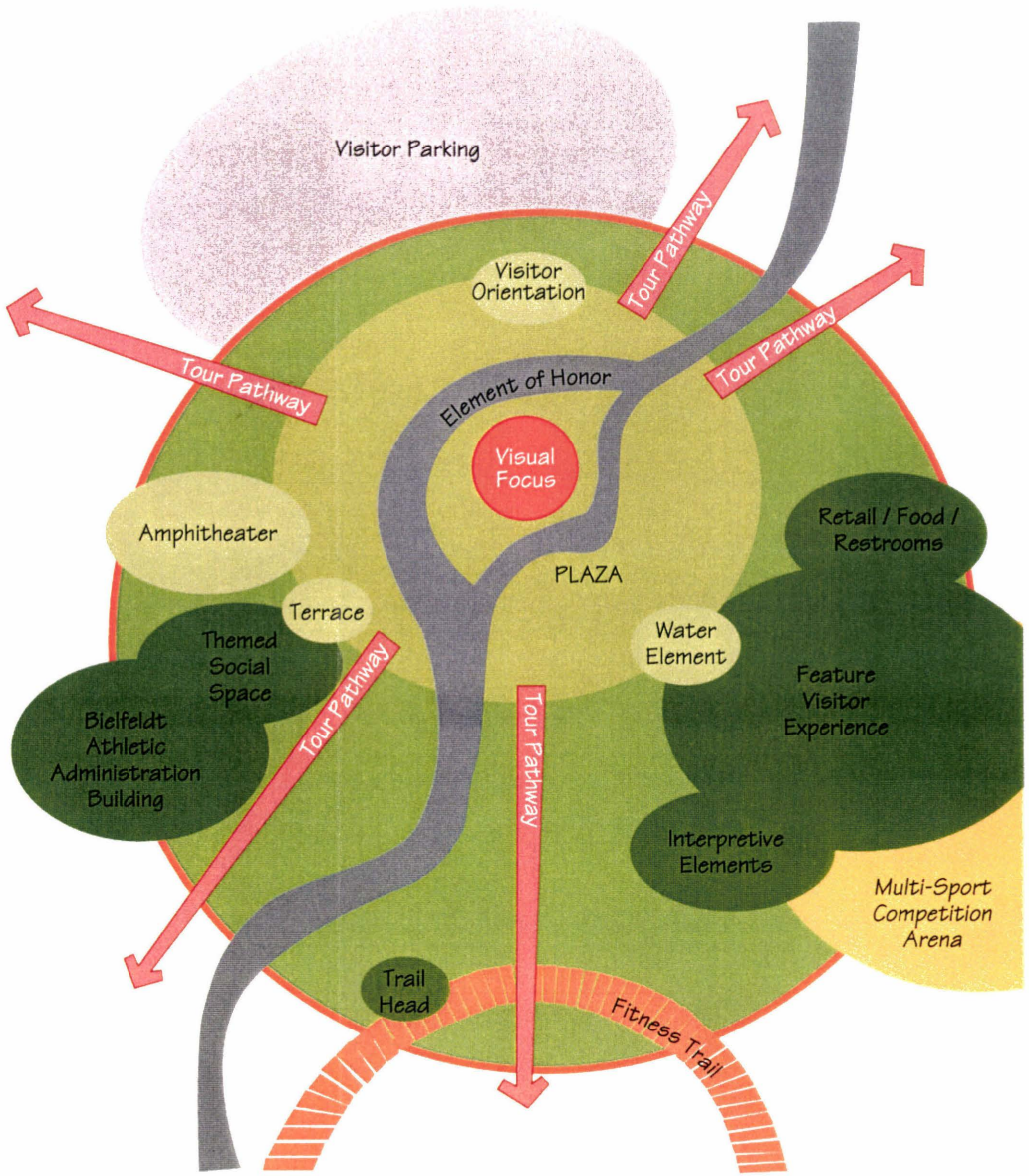

Illini Park Detail

Visitor Flow Diagrams

Architectural gateways visually welcome visitors to the Athletic Campus. Illini Park serves as the hub, providing visitor amenities, physical campus orientation, and a stirring thematic overview of the story of Illini athletics. Unifying campus architecture, landscape, and interpretive elements connect Illini Park to competition venues where visitors experience sport specific interpretation. Interpretive elements honor Illini greats, illuminate historical events, and celebrate sterling achievements.

Key

Future

Modern Venues

Historic Venues

Celebration of Sport

Inspirational/Humor/Human Interest

Essence of Sport Experience

History/Tradition



# SUMMARY REPORT

*The new University of Illinois Athletic Campus  
will become an unique environment that elicits  
a strong positive emotional reaction.*

## SITE BUILDING PROGRAM AND MASTER PLAN





## **Master Plan Approach**

### **Site Character and Natural Features**

The main goal of this Master Plan is to create an inviting and pedestrian-friendly environment. Site improvements will integrate with existing topography, providing retention/detention and permanent water features at lower elevations. Existing slopes will be utilized for grandstand seating at venues. Mature vegetation and trees are preserved by this plan. The prominence of the Bielfeldt Athletic Administration Building, and the east/west axis at the athletic campus are maintained and reinforced throughout the plan. Materials for site improvements will remain consistent and compatible with the materials and character of the main campus, utilizing red brick, limestone, deciduous canopy trees, flowering ornamental trees and evergreen hedges.

### **Adjacencies**

The Master Plan enhances the open space corridors to the recreation space (DCR) on the east, the potential golf course on the south, Assembly Hall on the west and Memorial Stadium to the northwest. It is assumed that the DIA will coordinate with Assembly Hall management for shared use and improvements consistent with the goals of Assembly Hall and DIA. Because the cemetery property line is relatively close to Fourth Street and Kirby/Florida Avenues, streetscape improvements and development east of Fourth and north of Kirby/Florida are avoided, and student and visitor use of the cemetery will be discouraged.

### **Utilities and Infrastructure**

The most cost effective and efficient utility distribution system relative to the proposed facilities will be developed by this Master Plan. Proposed facilities will be fed with safe and secure underground utility systems. Stormwater management in compliance with Urbana and Champaign ordinances will be required as new development occurs. The east side of the athletic campus lacks existing utility infrastructure, therefore new facilities in this area will require utility extensions for storm, sanitary, water and telecommunications.

### **Parking and Vehicular Circulation**

Shared parking lot agreements will be pursued by DIA with Assembly Hall management for event and staff parking. Event parking is designed on lawn areas that can be utilized as open space and practice fields when events are not occurring. Staff parking is available on permanent paved lots. Visitor parking for approximately 10-15 vehicles and drop-off will be provided at Bielfeldt,





as will a drop-off for the Visitor Center. The Master Plan calls for access to all parking to be from existing adjacent streets, eliminating the need for internal vehicular circulation routes. Due to the hours of operation of Atkins, adequate nearby parking with a drop-off is offered in this plan. If new facilities displace existing event parking, event parking will be replaced within viewing distance of the destination venue whenever possible. Vehicular gateways to the athletic campus at Goodwin/Florida and Oak/Kirby are also implemented in the Master Plan.

### **Pedestrian Circulation**

Conflicts between pedestrians and vehicles are minimized, if not eliminated, by this plan. Pedestrian linkage to campus via Fourth Street and to a future hotel/conference center to the south are designed, as well as jogging paths, bike trails and walks that loop throughout the athletic campus providing links to venues. Jogging paths and bike trails are connected with existing and proposed U of I and City/County path and trail systems. The east/west axis of the Athletic Campus is reinforced by maintaining and enhancing the pedestrian spine through the center of the complex. Direct routes from Bielfeldt to venues are implemented, since walking is the primary means of transportation for coaches and staff.

### **Buildings**

Future building construction within this Master Plan shall be responsive to the established and planned pedestrian circulation routes. The size, scale and design of future buildings shall be carefully considered in order to maintain unity between old and new. The visual heritage of the academic campus shall be reinforced at the athletic campus through the selective use of traditional forms, materials and detailing. However, the possibility of alternative material and design applications and/or recombinations of traditional elements which are appropriate and expressive of new, innovative athletic facilities shall also be explored.

### **Service and Maintenance**

Service and maintenance routes to venues from adjacent perimeter streets are proposed by this plan. The current U of I operation procedures are maintained by providing service, waste and maintenance facilities at each venue. Service drives and waste receptacles are screened by means of landscaping and trash enclosures.





### **Ubben/Bielfeldt Courtyard and Pedestrian Spine**

- Site  
The courtyard between Ubben and Bielfeldt includes decorative paving and walks that continue through the campus forming a pedestrian spine. Seat walls flank the courtyard and are backed with attractive landscaping and lawn areas. Decorative lighting and irrigation are also provided in this area.
- Building  
No building construction is planned within these areas.

### **Atkins Tennis Center**

- Site  
Eight new outdoor tennis courts with lighting are planned along with the proposed new outdoor tennis stadium. The entry plaza includes gateway features, new lighting, decorative paving, and walks. Utility service, a detention area, landscape improvements and irrigation are also provided.

- Building - Multiple Projects

#### Interior Remodeling

Limited general, mechanical and electrical work remodeling of portions of the first and second floors of the existing building is planned in connection with interpretive improvements.

#### West Entry Addition

A new, expanded entry vestibule and lobby on the west side of the existing building is planned including a second floor balcony overlook of the athletic campus.

#### Indoor Court Expansion

Additions to the north and south end of the existing building are planned resulting in two new courts and necessary storage space. Extension of the court viewing area on the second floor and required mechanical equipment space is also included.

#### Outdoor Tennis Stadium

A new permanent outdoor tennis stadium is planned for the east side of the existing Atkins Tennis Center overlooking the proposed eight new outdoor courts. This facility will have a seating capacity of 2000 for tournaments and includes concessions, restrooms, press box, pro-shop and other required spaces. The stadium concourse will be linked to and through the existing building at the second floor level. This project will anchor the eastern end of the athletic campus and help define the new athletic campus entry from Goodwin Avenue.





### **East Athletic Campus Entry**

- Site

A new drive with a drop-off area and parking is planned for the east entry of the athletic campus. The entry provides pedestrian walks, special gateway features, exterior lighting, new landscaping and irrigation. Although the Heritage Master Plan displaces some campus recreation playfields adjacent to the Atkins Tennis Center shown in the South Campus Master Plan, they will be relocated to the Stadium Terrace area west of First Street.

- Building

No building construction is planned within this area.

### **Track/Soccer Courtyard and Field**

- Site

The entrance to the Track and Soccer Field receives a new courtyard with decorative paving and walks. Screen walls, exterior lighting, new landscaping and irrigation are included.

- Building - Multiple Projects

#### Track/Soccer Stadium

A new permanent stadium is planned for the east side of the existing outdoor track and soccer field. This facility will have a seating capacity of 3000 and includes concessions, restrooms, press box, changing rooms, a training area and required storage space.

#### West Stands

Permanent seating for approximately 1000 spectators is planned for the west side of the existing outdoor track and soccer field.

### **Ubben Basketball Practice Facility**

- Site

The Ubben Basketball Practice Facility will receive expanded parking and a staff/service drop-off. New lighting will be added to the parking area and walks. Landscape improvements and irrigation are also planned.

- Building - Multiple Projects

#### Interior Remodeling

Limited general, mechanical and electrical work remodeling of the lobby, first floor corridors and balconies is planned in connection with interpretive improvements.

#### Building Expansion

An addition to the eastside of the existing facility is planned to meet possible future needs including increased gymnasium space, locker facilities and staff offices.



### **Illinois Field (Baseball)**

- Site

New entry paving and walks are proposed in this Master plan. A practice infield will be added adjacent to the existing field. Pedestrian lighting, landscape improvements and irrigation are also added.

- Building - Multiple Projects

Spectator Stands Expansion

The expansion of the existing permanent stands to increase seating capacity from 1500 to 3000 is planned. Special seating areas will be created for donors.

Existing Baseball Building

Upon completion of new baseball locker facilities within the Multi-Sport Complex, the existing baseball building becomes available for much-needed equipment storage.

### **Eichelberger Field (Softball)**

- Site

Improvements to Eichelberger Field include new entry paving and walks, and pedestrian lighting. A practice infield will be added adjacent to the existing field. Additional landscape is proposed, including evergreen screening around the field, and new irrigation.

- Building - Multiple Projects

Press Box

A permanent press box building is planned including facilities for the media, scorekeeping and scoreboard and message center control.

Venue Service Building(s)

A permanent building providing space for ticket sales, restrooms, concessions and associated storage is planned. Another building is planned for storage relating to field maintenance.

### **Memorial Stadium**

- Site

New entry courtyards and walks with decorative paving are designed around Memorial Stadium. The grounds around the Stadium will receive pedestrian lighting, landscape improvements and irrigation. Renovation of the playing field is also planned.



## **Memorial Stadium (Continued)**

- **Building - Multiple Projects**

### Interior Remodeling

General and electrical work remodeling is planned in connection with interpretive elements at the stair towers, great halls and colonnades.

### Exterior Remodeling

General and electrical work remodeling is planned in connection with interpretive elements along the east and west walkways outside of the stadium.

### Press Box Addition

Designed to be compatible with the historic Memorial Stadium, this proposed state-of-the-art facility will include a 150 seat press and media area, 500 seat club level, 40 luxury boxes and essential game day support space for DIA operations.

### South Stands (Horseshoe) Replacement

The first phase of Memorial Stadium restoration work was completed in 1992 and focused on the east and west main stands, the balconies and related work in the great halls and ramp towers. A second phase is planned that includes the replacement of the south stands, related service areas for spectators and stadium maintenance and improvements in accessibility. The design will feature a colonnade memorial to those who gave their lives in conflicts following World War I.

### Irwin Football Complex Addition and Remodeling

An addition to the varsity football facility over the existing patio area is planned to allow for expansion of the existing locker, training and equipment storage facilities. Existing and new meeting rooms and offices are displaced into the addition while the existing patio is relocated to the roof of the addition.

### North End Zone Project

Permanent seating at the north end zone is planned including related restrooms, concession facilities and storage under the new stands. By moving this seating close to the playing field, a new parking lot can be created to the north, while still leaving service access to IMPE and the Varsity Football Facility intact. "Zuppke Field" stone work will be relocated to the face of the new stands.



### **Irwin Football Practice Facility**

- Site  
The Master Plan provides a new entry for Irwin Football Practice Facility, including decorative paving and walks. New lighting is added, as well as landscape improvements and irrigation.
- Building  
Limited general, mechanical and electrical work remodeling of the lobby and practice area is planned in connection with interpretive improvements.

### **Assembly Hall**

- Site  
Entry courtyards and walks, along with new lighting are proposed in this Master Plan. Landscape improvements and irrigation are also included.
- Building  
Limited general, mechanical and electrical work remodeling of the main entry/lobby in connection with interpretive improvements is planned.

### **IMPE Pool**

- Site  
The entrance courtyard to the IMPE Pool includes decorative paving and walks. New lighting is provided and the courtyard receives new landscaping and irrigation.
- Building  
No building construction is planned within this existing facility.

### **Huff Hall**

- Site  
The plan calls for new entry courtyards and walks, along with new lighting at Huff Hall. Landscape improvements and irrigation are also included.
- Building  
No building construction is planned within this existing facility.

### **Armory**

- Site  
The grounds around the Armory receive new entry courtyards and walks. New pedestrian lighting is included, as well as landscape improvements and irrigation.
- Building  
No building construction is planned within this existing facility.

### **Irwin Academic Center**

- Site  
Irwin Academic Center is provided with landscape improvements and irrigation. Streetscape improvements, pedestrian lighting and street trees are planned for Fourth Street.
- Building  
No building construction is planned within this existing facility.

### **Gateways**

The intersections of Kirby Avenue and Fourth Street, Florida Avenue and Oak, and Florida Avenue and Goodwin all receive gateway features. These intersections include specialty paving at the corners and on the road surface, as well as new crosswalks. Other features include seat walls and fences framing the intersections. New lighting, landscape treatment, and irrigation are also included.

### **Streetscapes**

Streetscape improvements include new sidewalks and crosswalks, along with seating nodes with walls and fences. New lighting is provided, and new landscape features with irrigation, and additional street trees are planned.

### **General**

Overall, the entire campus is provided with general site improvements. Lawn parking for events is designed to accommodate additional vehicles. Jogging paths are added around the campus, separate from pedestrian walks. Throughout the campus, new lighting, landscape and irrigation are provided.



Keyed Master Plan

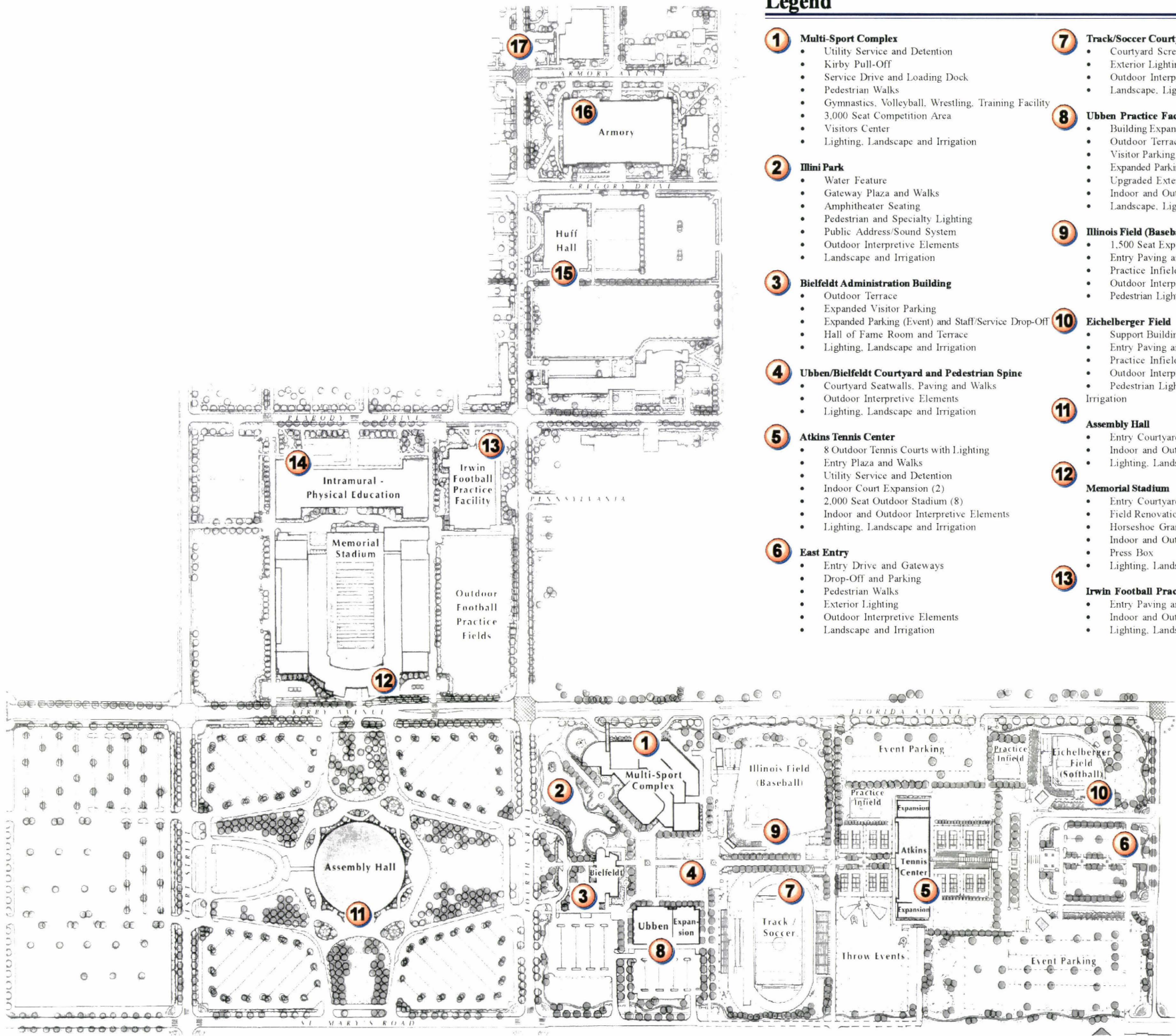

**Legend**

- 1 Multi-Sport Complex**
    - Utility Service and Detention
    - Kirby Pull-Off
    - Service Drive and Loading Dock
    - Pedestrian Walks
    - Gymnastics, Volleyball, Wrestling, Training Facility
    - 3,000 Seat Competition Area
    - Visitors Center
    - Lighting, Landscape and Irrigation
  - 2 Illini Park**
    - Water Feature
    - Gateway Plaza and Walks
    - Amphitheater Seating
    - Pedestrian and Specialty Lighting
    - Public Address/Sound System
    - Outdoor Interpretive Elements
    - Landscape and Irrigation
  - 3 Bielfeldt Administration Building**
    - Outdoor Terrace
    - Expanded Visitor Parking
    - Expanded Parking (Event) and Staff/Service Drop-Off
    - Hall of Fame Room and Terrace
    - Lighting, Landscape and Irrigation
  - 4 Ubben/Bielfeldt Courtyard and Pedestrian Spine**
    - Courtyard Seatwalls, Paving and Walks
    - Outdoor Interpretive Elements
    - Lighting, Landscape and Irrigation
  - 5 Atkins Tennis Center**
    - 8 Outdoor Tennis Courts with Lighting
    - Entry Plaza and Walks
    - Utility Service and Detention
    - Indoor Court Expansion (2)
    - 2,000 Seat Outdoor Stadium (8)
    - Indoor and Outdoor Interpretive Elements
    - Lighting, Landscape and Irrigation
  - 6 East Entry**
    - Entry Drive and Gateways
    - Drop-Off and Parking
    - Pedestrian Walks
    - Exterior Lighting
    - Outdoor Interpretive Elements
    - Landscape and Irrigation
  - 7 Track/Soccer Courtyard and Field**
    - Courtyard Screenwalls, Paving and Walks
    - Exterior Lighting
    - Outdoor Interpretive Elements
    - Landscape, Lighting and Irrigation
  - 8 Ubben Practice Facility**
    - Building Expansion
    - Outdoor Terrace
    - Visitor Parking
    - Expanded Parking and Staff/Service Drop-Off
    - Upgraded Exterior Lighting
    - Indoor and Outdoor Interpretive Elements
    - Landscape, Lighting and Irrigation
  - 9 Illinois Field (Baseball)**
    - 1,500 Seat Expansion
    - Entry Paving and Walks
    - Practice Infield
    - Outdoor Interpretive Elements
    - Pedestrian Lighting, Landscape and Irrigation
  - 10 Eichelberger Field**
    - Support Buildings and Press Box
    - Entry Paving and Walks
    - Practice Infield
    - Outdoor Interpretive Elements
    - Pedestrian Lighting, Landscape and Irrigation
  - 11 Assembly Hall**
    - Entry Courtyards (4), Paving and Walks
    - Indoor and Outdoor Interpretive Elements
    - Lighting, Landscape and Irrigation
  - 12 Memorial Stadium**
    - Entry Courtyards (4), Paving and Walks
    - Field Renovation
    - Horseshoe Grandstand Seating
    - Indoor and Outdoor Interpretive Elements
    - Press Box
    - Lighting, Landscape and Irrigation
  - 13 Irwin Football Practice Facility**
    - Entry Paving and Walks
    - Indoor and Outdoor Interpretive Elements
    - Lighting, Landscape and Irrigation
  - 14 IMPE Pool**
    - Entry Paving and Walks
    - Outdoor Interpretive Elements
    - Lighting, Landscape and Irrigation
  - 15 Huff Hall**
    - Entry Paving and Walks
    - Outdoor Interpretive Elements
    - Lighting, Landscape and Irrigation
  - 16 Armory**
    - Entry Paving and Walks
    - Outdoor Interpretive Elements
    - Lighting, Landscape and Irrigation
  - 17 Irwin Academic Center**
    - Indoor Interpretive Elements
- Gateways**
- Specialty Paving and Crosswalks
  - Seat Walls and Fences
  - Lighting, Landscape and Irrigation
- Streetscapes**
- Sidewalks and Crosswalks
  - Seating Nodes with Walls and Fences
  - Lighting, Landscape and Irrigation
- General**
- Lawn Parking (Event)
  - Jogging Paths
  - Lighting, Landscape and Irrigation

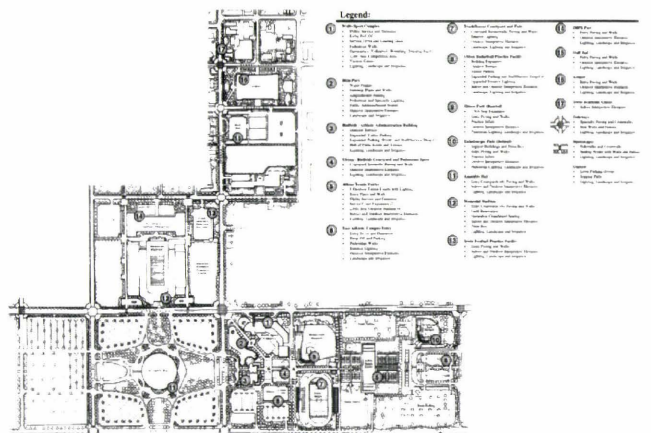



Enlarged Master Plan - Athletic Campus

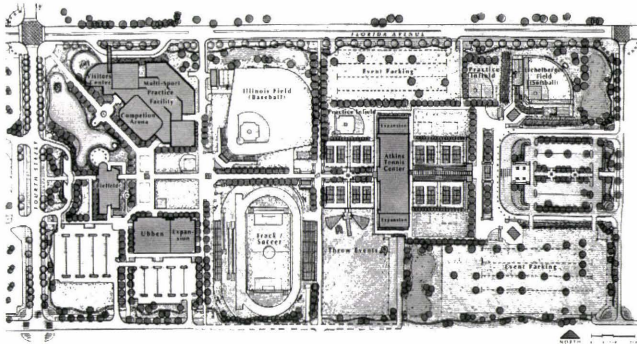
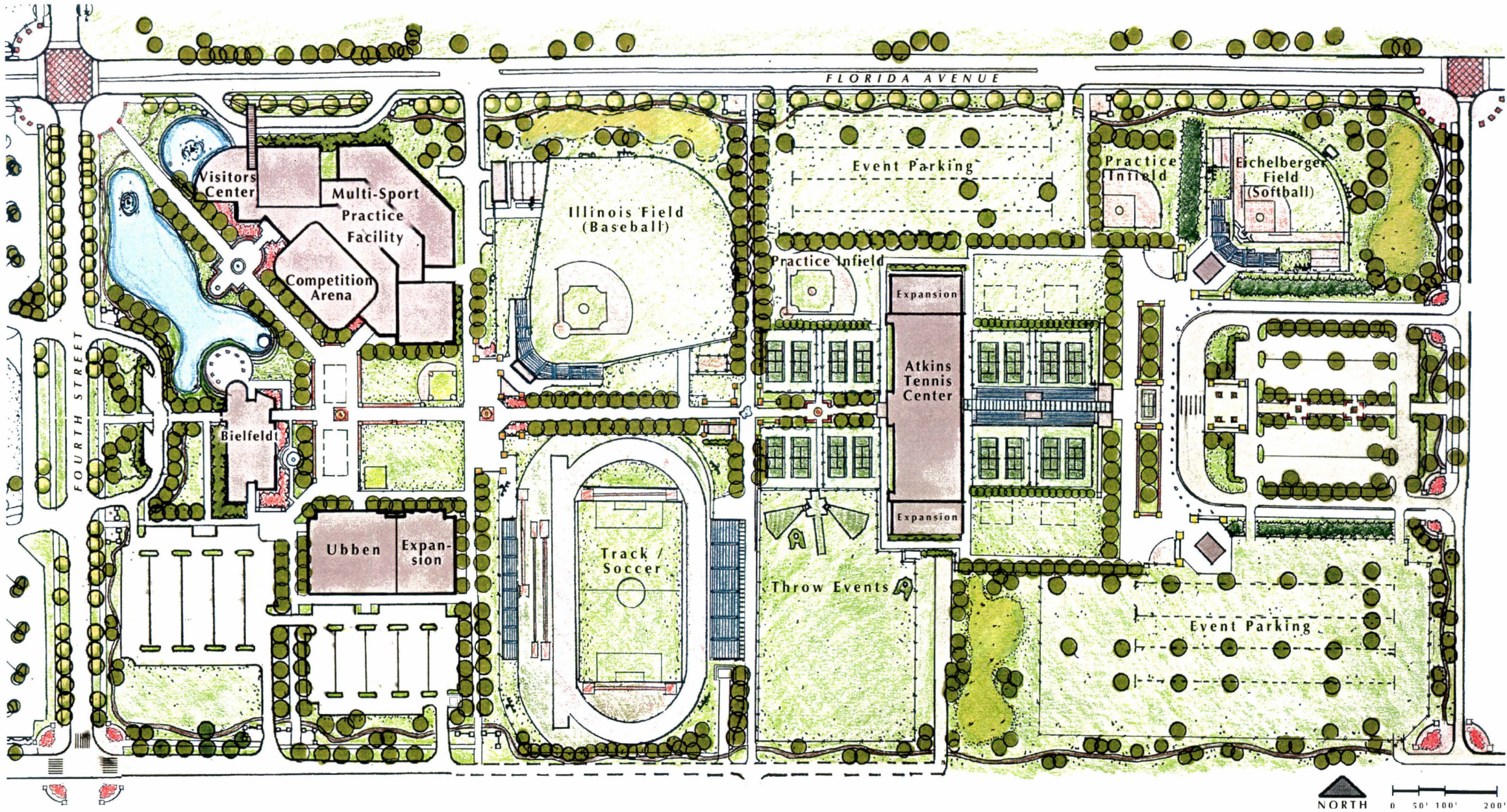



# SUMMARY REPORT

*With speed, strength, agility, courage, integrity, and intelligence, Fighting Illini student-athletes have competed against the nation's best for more than 100 years. The University of Illinois' proud athletic heritage showcases some of the great moments and individuals in intercollegiate sports.*

## INTERPRETIVE CONCEPTS





## **Interpretive Concepts**

**Multi-Sport Complex**

**Illini Park**

**Bielfeldt Athletic Administration Building**

**Ubben-Bielfeldt Courtyard and Pedestrian Spine**

**Atkins Tennis Center and East Entry Plaza**

**Ubben Basketball Practice Facility**

**Memorial Stadium**

**Irwin Football Practice Facility**

**Assembly Hall / IMPE Indoor Pool / Huff Hall / Armory**

**Irwin Academic Center**



## Multi-Sport Complex

### Main Message

With speed, strength, agility, courage, integrity, and intelligence, Fighting Illini student athletes have competed against the nation's best for more than 100 years. The University of Illinois' proud athletic heritage showcases some of the great moments and individuals in intercollegiate sports. The games have been a continual source of excitement, inspiration, and renewal, bringing diverse community members together in enthusiastic celebration of the youthful pursuit of athletic excellence.

### Interpretive Strategy

The Visitor Center, located prominently in Illini Park inside the New Multi-Sport Complex, provides a physical orientation to the Athletic Campus, offers visitor amenities, and captivates visitors with a unique and powerful look at more than 100 years of Fighting Illini athletics. A grand lobby, shared with the Multi-Sport Complex, features a stunning sculptural element honoring Illini Athletes of the Year. A 15-18 minute multi-media Orientation Experience imbues visitors with the sounds, colors, and pageantry of the games, moving from Red Grange to Dick Butkus to Lou Boudreau, Kendall Gill, Mary Eggers, Tonja Williams, and others. Visitors emerge from the Orientation Experience with a richer understanding of the University of Illinois tradition, ready to tour remaining campus offerings.

From the Orientation Experience, visitors peruse the Illini A to Z gallery where they view artifacts from legendary players and coaches in a surprising and ever-changing arrangement. Here, "A" stands not for "apple" but for "Agility" as visitors see stunning images of gold medalist Harold Osborn clearing the high jump bar or gymnast Karen Brems somersaulting on the balance beam. "B" stands for Butkus and/or "bone-jarring" as visitors watch video clips of the phenomenal linebacker's intimidating hits. "B" could also stand for "buzzer-beater," as visitors watch great all-time finishes inside Assembly Hall. The gallery's modular design allows ongoing flexibility. Visitors know intuitively how to navigate the space, but find themselves guessing what the next letter will stand for. Interactive exhibits are mixed with artifactual displays to appeal to visitors of varying ages, educational backgrounds, and learning styles. A computer lookup system allows visitors to find statistical information on all Illini letter-winners.





## Interpretive Highlights

- Physical Orientation to the Athletic Campus - The Visitor Center acts as an information hub, orienting visitors to the campus and presenting information about available options. Possible offerings include walking tour maps, guided tours, season schedules, and computer kiosks that allow visitors to tailor their own campus tour. Personalized sport player cards connect visitors to Illini greats. Interpretive elements at each venue refer visitors back to the Visitor Center at the Multi-Sport Complex.
- Thematic Orientation Experience (app. 2,500-3,000-sq. ft., accommodating 75-100 visitors) -  
- An explosive "knock-your-socks-off" experience conveys the excitement and tradition of Illini athletics by presenting all-time great moments, performances, teams, and individuals. The experience combines state of the art audiovisual technology, three-dimensional objects, and magical theatrics. It is neither a movie nor a play, but something in between. The experience may be a pulsed show with a starting and ending time lasting 15-18 minutes, or a continuous, immersive walkthrough experience that visitors enjoy at their own pace.
- Visitor Amenities - Athletic-themed cafe and team store, restrooms, and ticket sales venue (shared function with Assembly Hall). Convenient vehicular access to the Multi-Sports Complex offers temporary parking allowing visitors to purchase/pick-up tickets.
- Illini A to Z Gallery (app. 3,000 sq. ft.) -- Interprets Illini athletics through artifacts, images, graphics, and interactive exhibits, i.e. B is for "Buzzer-beater", G is for "Galloping Ghost", U is for "Upset", S is for "Splash", W is for "Whiz Kids". The gallery includes computer touchscreens where visitors can look up and even get a printout of information about Illini letter-winners.
- Temporary/Changeable Gallery (app. 1,000 sq. ft.) -- Offers opportunities to celebrate recent accomplishments or do special features on notable anniversaries. The gallery may also function as a flexible program space.
- Themed Lobby -- Shared with the Multi-Sport Arena, the Lobby features a powerful sculptural element celebrating Illini Athletes of the Year that is also visible from the building's exterior. Large banners and scrims herald Illini athletics with overhead imagery from many time periods. Game announcer-like audio tracks enliven the space and can be tailored to make special announcements or welcome particular groups. The DIA Mission Statement and special donor recognition are displayed.
- Baseball Clubhouse -- The East Side of the Multi-Sport Complex contains a themed viewing space overlooking the baseball field. Historic images and shallow artifact cases highlight baseball's long and stellar history.





**Visitor Center Gallery Sketch**

Illini A to Z - Everyone knows the alphabet, but how many people know that A stands for the “agility” of gymnast Karen Brems, or that B stands for “bone-crushing” tackles by Dick Butkus? Visitors find fun and surprises in this ever-changing gallery of Illini highlights, artifacts, and interactive exhibits. Computer databases give stats on Illini letter-winners and show where they are featured in the gallery or elsewhere on campus.

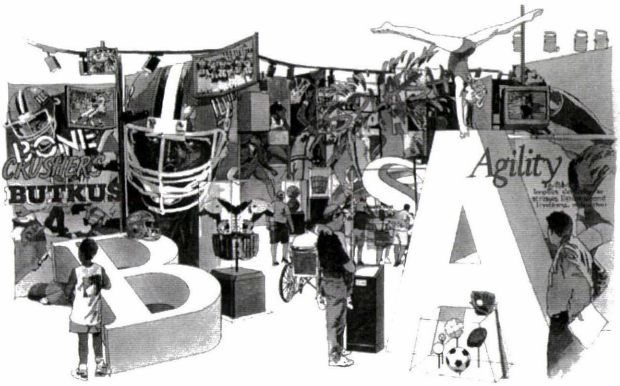
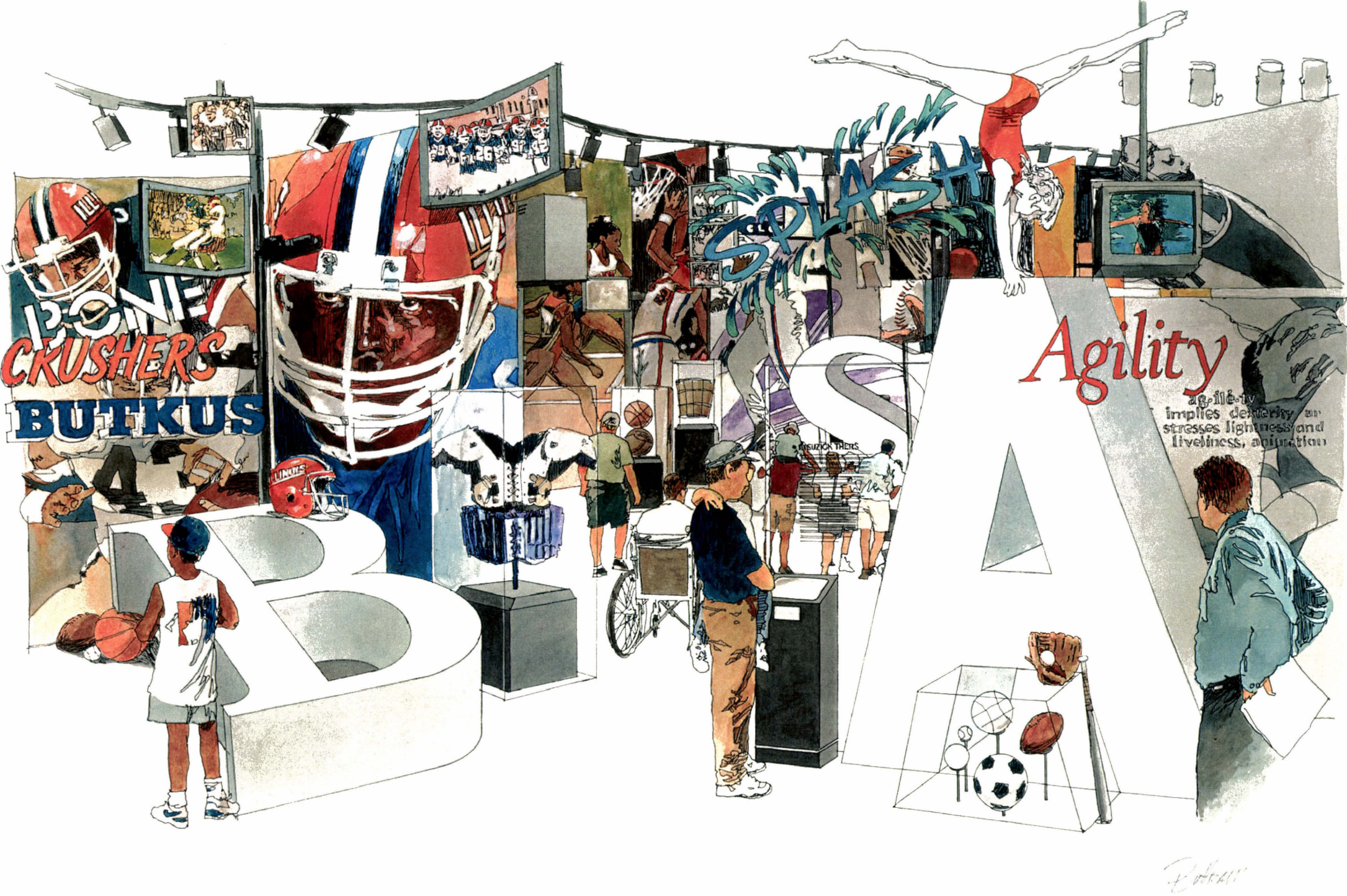



## **Illini Park**

### **Main Message**

Welcome to the University of Illinois, home of Fighting Illini student athletics. Our rich tradition of excellence includes national champions, Olympians, and scholar athletes. We are committed to fielding teams that can compete successfully against the nation's best while also preparing student athletes to take leadership roles in their communities.

### **Interpretive Strategy**

Illini Park welcomes and orients visitors to the Athletic Campus and announces the rich tradition of the Fighting Illini through a combination of sculptural gateways, streetscape wayfinding elements, a dramatic water element, kinetic sculptures, flags, pennants, and other iconic symbols of Illini and Big Ten athletics. The Park entrance is strategically located at the intersection of Fourth and Kirby, uniting the historical and contemporary section of the Athletic Campus - a block "I" marks the spot.

Illini Park draws inspiration from the Midwestern town square. Here, visitors are oriented to campus offerings, may purchase tickets, and are introduced to the heritage and values that embody University of Illinois athletics. The Bielfeldt Athletic Administration Building and the new Multi-Sport Complex anchor the Park on the South and East. Illini Park combines hardscape, green spaces, an outdoor amphitheater, and architectural elements to blur the lines between outdoor and indoor spaces and create a friendly, flowing atmosphere.

### **Interpretive Highlights**

- Exterior Visitor Kiosk -- Visitors may drop by to obtain orientation information about Athletic Campus activities at any time of day.
- Water Feature -- A retention pond accomplishes necessary water retention in a way that helps define and adorn Illini Park. Interpretive elements may take a variety of forms: fountain with athletic themed sculpture, random spritzers, water activated kinetic sculpture, waterfall, water path paralleling visitor trail, Big Ten medalist water sculpture, messaging element (water clock, signal for Illini victory/defeat).
- Flags, pennants, Big Ten symbols -- Colorful icons might be raised/lowered or specially lit to accent current or upcoming competitions.



- LED Screens -- Displayed in artistic shapes, LED Screens complement and activate the Multi-Sports Complex exterior. Screens may show in-progress competition, recent highlights, or historic footage. Screens are programmable to support amphitheater uses.
- Outdoor Amphitheater -- A gathering space for outdoor programs accommodating 250-500 people - coaching clinics, summer camps, award ceremonies, rallies, and celebrations. Part grass, part hardscape, the amphitheater includes sculptural seating and landscaping that lend unique character to Illini Park.
- Whirligigs, cast-sculptural figures, and/or topiaries suggest athletic movements. Sculptural benches offer adults places to relax while children enjoy the Park. Benches may suggest athletic equipment or movements. Interpretive play elements give visitors a chance to test their skills against Illini greats. Such elements are repeated throughout the Athletic Campus in various forms.
- Landscaping -- Interpretive landscaping opportunities unite the Athletic Campus with a consistent wayfinding, abutment, and gateway vocabulary. Landscaping interpretation may take the form of Hall of Fame honoring elements or memorial plantings, and may establish connections to the region's prairie heritage.



## **Bielfeldt Athletic Administration Building**

### **Main Message**

The University of Illinois is committed to the total individual. Student athletes arrive on campus filled with promise. During their collegiate careers, they develop their athletic abilities while gaining a more mature understanding of themselves and their potential off the field. They form lasting bonds with coaches and teammates. They graduate well equipped to pursue professional careers and take leadership roles in their communities.

### **Interpretive Strategy**

Interpretation at Bielfeldt Administration Building highlights the University of Illinois' strong commitment to academic and athletic excellence. An inspiring sculptural element, located on a new exterior terrace just off the current social function room, celebrates these ideals by honoring Big Ten Medal of Honor winners. Inside the themed social space, visitors are surrounded by iconic images of Illini athletes rendered in frosted glass. Fine jewel cases display national awards won by teams and individuals. An array of flatscreen monitors periodically transforms the space with an evocative sound and light show taking visitors behind the scenes and introducing them to players and coaches that made the awards possible. Visitors hear about the hard work, discipline, courage, and imagination that student athletes carry with them in practice, in competition, and beyond in their professional lives. Themed lighting sets off the space at night, making it a beacon on the Athletic Campus.

### **Interpretive Highlights**

- The Themed Social Space and the future Visitor Center Orientation Experience function as brother and sister in Illini Park. Both shows are strong, emotionally evocative pieces that celebrate and explore the Illini student athlete experience, but they differ in shades of emphasis. The Bielfeldt show says, "What we aspire to!" The Visitor Center show says, "Who we are!" The Bielfeldt show has a more elegant, spiritual, feel to it -- focusing on Illini core values and individuals that have embodied those ideals. The Visitor Center show is more gritty and explosive. Both shows emphasize bringing together diverse peoples and making connections with surrounding communities.

- The new terrace with its Big Ten Medal of Honor sculpture has a prominent visible connection to the themed social space. On select occasions, visitors may exit the themed social space directly to the terrace. Visitors may also enjoy the terrace from Illini Park, but public access is easily limited during special functions.
- Interpretation in the themed social space is flexible, respecting the continuing function of the space for parties and other social gatherings. Interpretive elements are above and around visitors. Central floor elements are easily moved to make room for gatherings.
- Jewel box cases feature DIA's most impressive awards -- national championships, Big Ten titles, national individual awards, Olympic medals.
- Plasma screens and a strong ambient audio track envelop visitors in the space. Visitors activate the show by triggering motion sensors.
- Overhead elements may include banners, translucent scrims, oversized athletic objects, and abstract sculptural elements.
- Main Hallway -- Portable temporary exhibit kiosks or freestanding panels offer opportunities for announcing upcoming events and/or recent achievements. All donors are recognized in this space, although recognition elements for specific donors also take place elsewhere.



**Bielfeldt Sketch**

Illini Values and Aspirations - Images of Illini greats appear in frosted glass while fine jewel cases display major national and Big Ten awards. A dramatic audiovisual show periodically transforms the space, communicating Illini core values and highlighting individuals that best embody them. Visitors exit the space to a new terrace featuring a Big Ten Medal of Honor sculpture.

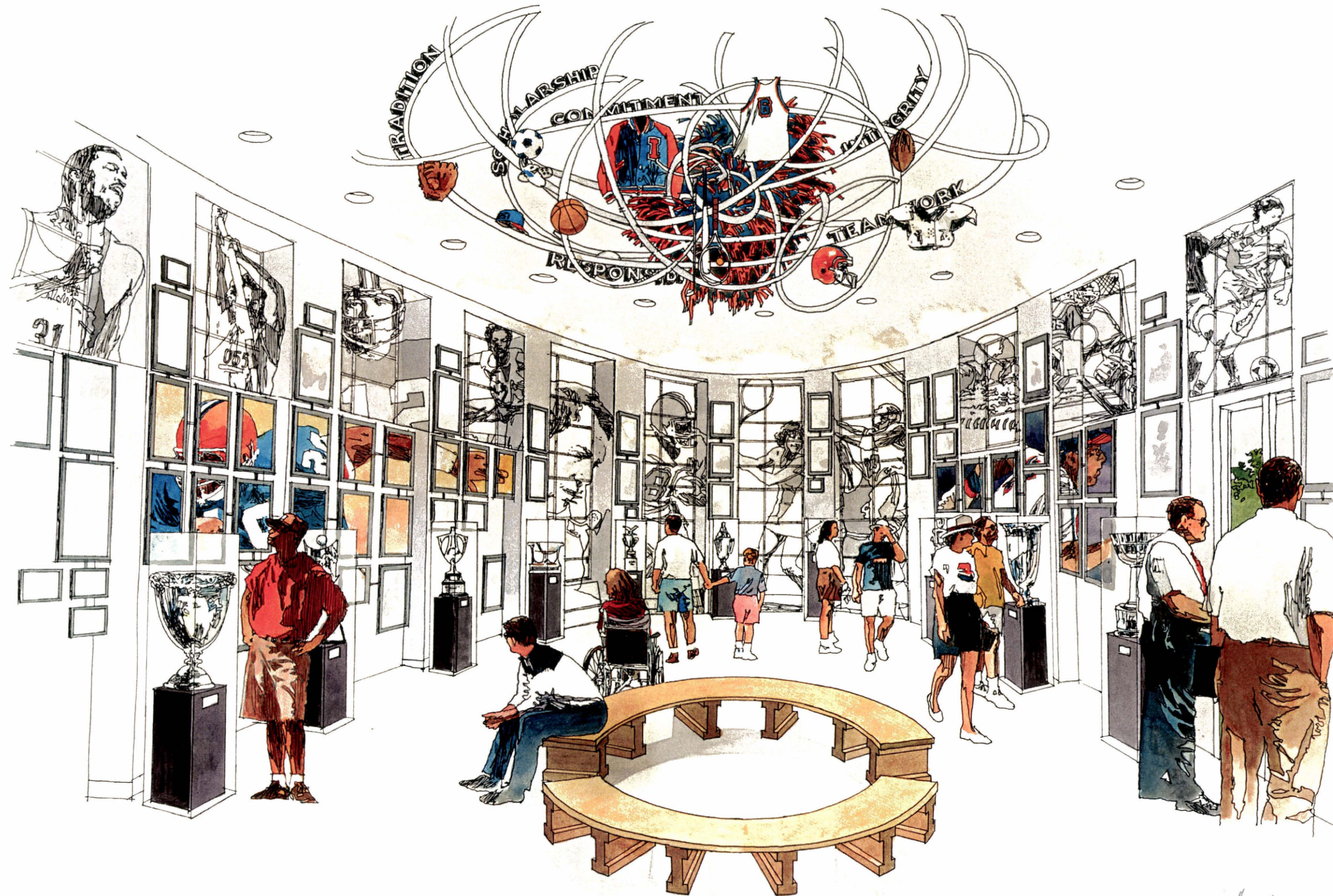



## Ubben-Bielfeldt Courtyard and Pedestrian Spine

### Main Message

All visitors are invited to enjoy and participate in the games. Fighting Illini athletics are rooted in the playful exuberance of youth. The Illini athletic heritage spans more than 100 years. During that time, the games and individuals have changed, but the spirit remains.

### Interpretive Strategy

Architectural pergolas, gateways, sculptures, and natural elements define the Center Spine through the southern portion of the Athletic Campus connecting Bielfeldt Athletic Administration Building to the Atkins Tennis Center. Interpretive panels and sculptural elements along the spine honor Illini Hall of Famers. The Center Spine bisects two Courtyards where sports played in the surrounding fields are interpreted -- adjacent to Ubben/Bielfeldt/Multi-Sport and between Illini Field/Atkins Tennis/Track/Soccer. Each courtyard suggests a slightly more intimate space than the more open East and West entry plazas. They serve as interpretive entry portals to adjacent competition venues while enveloping visitors in a "secret garden" atmosphere that invites them to pause, discover and play.

### Interpretive Highlights

- Interpretive elements along the Center Spine extend from and connect the two entry plazas. A consistent architectural vocabulary, carried on throughout the Athletic Campus, unifies the venues and supports a more intuitive visitor experience.
- Playful sculptures of sandlot baseball, barnyard basketball, relay races, backyard soccer, or lawn tennis may be displayed along with interpretive/sculptural benches and objects that youthful visitors can play on or around. The sculptures punctuate connections to childhood and suggest various historical eras in which Illini athletes have competed.
- Whirligigs emphasize athletic movements -- a relay runner handling off a baton, sprinters moving in tandem, a softball pitcher's arm motion, and discus thrower spinning in the wind. Sculptural benches may take the form of athletic equipment or figures. They offer visitors photo opportunities or simply, places to relax.
- Interpretive nodes within the courtyards offer opportunities for highlighting great/special moments and individuals in track & field, baseball, soccer, softball, and tennis. Interpretive elements may include viewing scopes for watching live action, or video/viewmaster binoculars that show historic images.





- Interactive elements challenge visitors to match their abilities with Illini greats. For example, a long jump record is articulated in the grass in real distance with an interpretive panel that describes outstanding Illini jumpers.
- Visitor ticketing and amenities are offered as select locations along the spine.





## Ubben Interpretive Courtyard Sketch

Rural and Urban Roots - Playful exterior sculptures remind visitors of the childhood roots and spirit of the games and, in this case, to basketball's historic links to farms and city playgrounds. Sculptures announce competition and practice venues and contribute to a new, unifying interpretive vocabulary for the Athletic Campus. Other sculptures show sandlot baseball or playground football with kids drawing plays in the dirt.

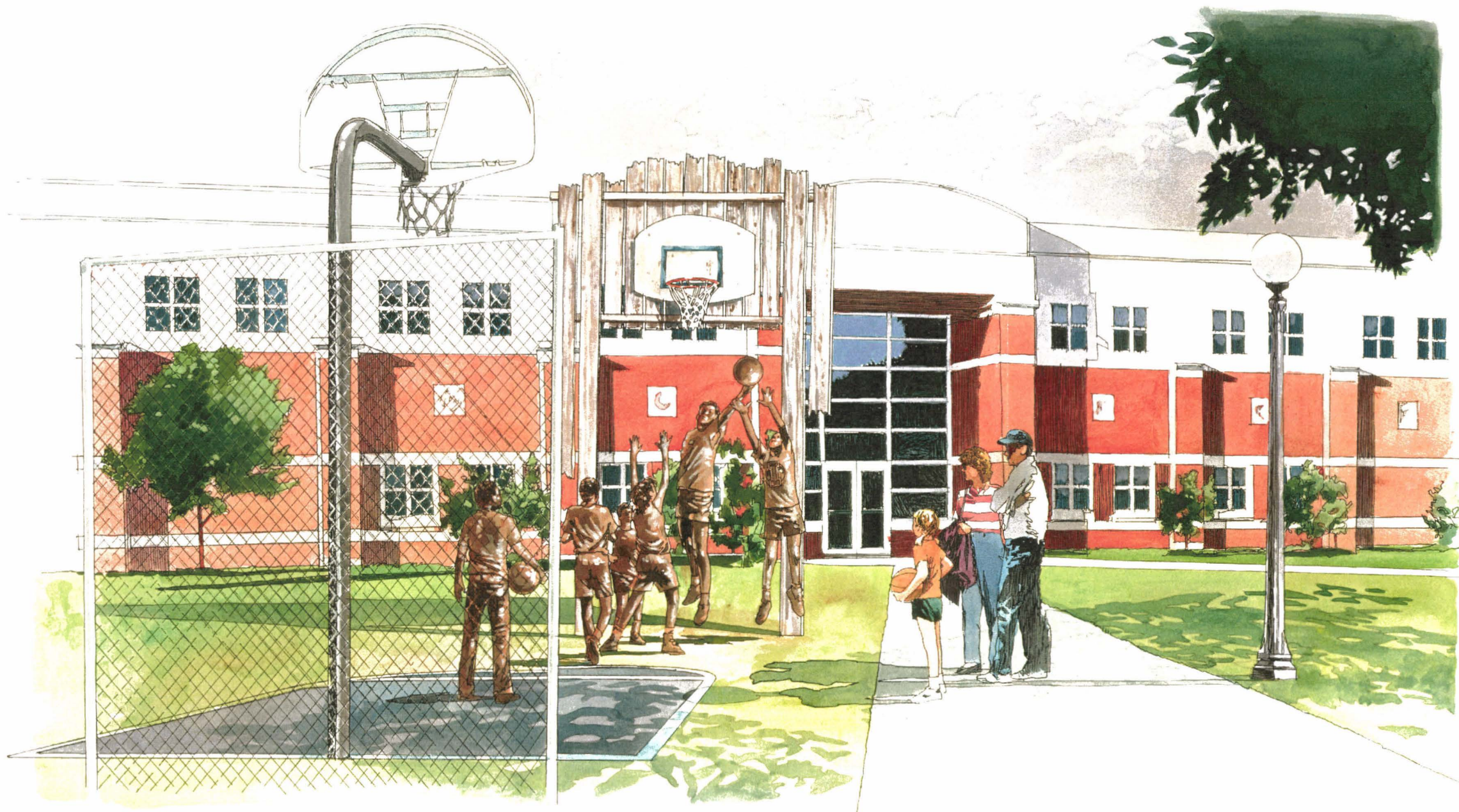



## **Atkins Tennis Center and East Athletic Campus Entry**

### **Main Message**

The University of Illinois tennis history extends back to 1909 when it became the first team west of the Allegheny's to gain entrance into the National Tennis Association. Fighting Illini teams proudly boast early and recent dominance in the Big Ten.

### **Interpretive Strategy**

The current structure affords limited interpretation in shallow wall-mounted artifact cases and photographic imagery (murals, banners, scrim, lenticular graphics) in the lobby and possibly upstairs. The expanded center, with new stadium courts on the East side, will put the University of Illinois in position to host major tournaments such as the NCAA Championships. Expanded parking along a new entry drive with interpretive landscaping announces the Tennis Center as the Eastern door to the Athletic Campus. From the entry drive drop-off point, visitors walk through a whimsical sculpture of children playing tennis to enter the stadium courts. An expanded lobby orients visitors to the Athletic Campus and interprets Illini tennis history. Gateway, wayfinding, and sculptural elements outside Atkins use similar motifs as Illini Park and the interpretive courtyards. Exterior interpretation may include topiaries, cast/sculptural figures, and/or whirligigs to accent tennis, softball, and possible future equestrian competition.

### **Interpretive Highlights**

- Computer touchscreen offers opportunities for visitors to look up Illini tennis greats.
- Expanded tennis center includes new clubhouse/themed lobby. Interpretation will be associated with reconfigured indoor courts in conjunction with expansion of center and addition of new outdoor courts.
- Visitor ticketing and amenities may be included here.



## Ubben Basketball Practice Facility

### Main Message

Fighting Illini basketball reaches back to the early days of the sport and features national champions, final fours, upsets, buzzer beaters, Whiz Kids, and high-flying action.

### Interpretive Strategy

Interpretation inside the Ubben practice facility is largely two-dimensional, relying on images to convey the historical sweep and excitement of Illini men's and women's basketball. Large images feature outstanding athletes and coaches and great moments within the two practice gyms and along surrounding corridors. Graphics note significant milestones such as the 1915 national championship team, the 1979 victory over Magic Johnson's Michigan State team, the 1982 triple-overtime win over #2 Long Beach State, or the 2001 trip to the Elite Eight. Lenticular images may be used to create a sense of movement and surprise. Entry portals accent recent accomplishments and individuals.

### Interpretive Highlights

- North entry portal includes strong sculptural element - perhaps a Nike/Jordanesque sculpture of a player dunking a basketball overhead.
- Long corridors provide opportunities to display inspiring photographs that visually convey the long tradition of Illini basketball.
- Wall outside practice gym may contain large, dynamic mural of game in progress -- perhaps suggesting the feel of frosted acrylic as if game is in progress on other side.
- A new/expanded entry, slightly larger than the North entry, might be considered on the South side.



## **Assembly Hall, IMPE Indoor Pool, Huff Hall and Armory**

### **Main Message**

The University of Illinois' tradition of excellence in gymnastics, swimming & diving, track & field, basketball, and volleyball stretches more than a century and includes national champions, Big Ten titlists, and Olympians.

### **Interpretive Strategy**

Each of these buildings has multiple uses and none are currently under the direct control of the DIA. These buildings are also limited in terms of available interior exhibit space. The current recommendation for interpretation includes exterior sculptures, stylistically consistent with Illini Park and the interpretive courtyard sculptures, announcing the sports that have been housed in each venue. Accompanying historical markers provide a brief overview of the venue. Interior interpretation should be limited to two-dimensional imagery and graphics in venue lobbies and halls. If the use or management status of any of the venues changes, the interpretive strategy should be reassessed.

### **Interpretive Highlights**

- The green space south of Huff Hall might feature a sculptural element similar to the interpretive courtyard sculptures -- kid's version of the games (volleyball and gymnastics). Inside Huff Hall, the large mural is refurbished (or possibly removed to another venue such as the Multi-Sport Visitor Center). Lobby and hall spaces are used to display images (perhaps poster size broadsides) of competition over a long time period.
- Exterior signage/graphics is consistent with the vocabulary used all along 4th street. Hall of Fame honoring elements are included, similar in style to those displayed along Bielfeldt-Atkins pedestrian spine.
- Exterior interpretation visually reinforces the connection between Assembly Hall and Illini Park. Green spaces are themed with sculptural elements that suggest the athletic and artistic performances that take place inside. Basketball is interpreted on the East Side. Inside Assembly Hall, the concourse may use shallow display cases, evocative images and graphics, portable kiosks, and computer touchscreens to celebrate Illini basketball highlights and outstanding performances.

- Outside IMPE on the north side, a playful sculptural element suggests children swimming and diving in a pool. Interior graphics and signage highlight outstanding Illini athletes in swimming, diving, and water polo.





## Memorial Stadium

### Main Message

Fighting Illini football features transcendent coaches and players that helped define the collegiate game. The team's success includes Big Ten titles and Rose Bowl victories. The pageantry of the sport annually draws thousands of fans to historic Memorial Stadium to revel in homecoming and pre- and post-game tailgating traditions.

### Interpretive Strategy

Memorial Stadium offers a grand space for interpreting the spectacle and excitement of Fighting Illini football. Exterior sculptures, improved wayfinding, and natural elements enhance the West Lawn as the front door of the stadium. Inside the west concourse, large images, banners, and overhead figures chronicle the history of Illinois football. Inside the East concourse, similar exhibit media celebrate Illini Big Ten champions in every sport.

As visitors mount each of the four stair towers, they view hanging sculpture elements, theatrical scrim, video monitors or LED screens, lenticular images, and other two-dimensional elements that highlight outstanding players and coaches. A strong pre-game soundtrack mixes Coach Ray Eliot's "Proper State of Mind" pep talk, game highlights, crowd noises, and music to get fans juiced for the game. During the game, live action footage can be seen in the spaces.

On the colonnade level, the history of the stadium and its connections to World War I veterans is presented with tasteful interpretive panels.

### Interpretive Highlights

- West lawn interpretation may include Illini Hall of Fame honor elements, a topiary or sculptural tailgate/homecoming party, lifecast fan figures, and a football linemen bench (sculptural bench that looks like linemen poised for goal line stand - visitors can sit and relax on top of them, or pose next to them for photo opportunity). On the East Side exterior walk, honoring elements feature Illini Hall of Famers.
- Stair towers may make use of diacritic glass, reflective surfaces, or specialty lighting to activate spaces and make best use of ambient light from above.

- Concourse interpretation takes place above and on perimeter surfaces and uses large images, scrims, banners, and oversized objects. Interpretation is grand and celebratory. Sculptures of players may appear to burst through the walls. Milestone markers punctuate major achievements. The East Concourse is renovated to enclose and heat similar to West Concourse.
- Touchscreen monitors allow visitors to look up Illini gridiron players. Monitors may be portable and may be removed on game day if desirable.
- Artifacts are not displayed in this space for security and conservation reasons.





## **Irwin Football Practice Facility**

### **Main Message**

Illinois football teams compete on a big stage against the nations best.

### **Interpretive Strategy**

On the North Side of Irwin Football Practice Facility and at the terminus of Pennsylvania Avenue, exterior sculptures show children playing sandlot football, huddled together drawing plays in the dirt or teeing the ball for a field goal. Inside, Irwin offers the casual visitor a stunning view. Large trusses spanning the width of the facility fill up the eyes. Interpretation, limited to two-dimensional imagery, enhances this view by accenting the power, speed, and movements that characterize college football. Images may take the form of large New Deal School murals, photographs, lenticular images, and/or LED screens cut into dramatic shapes. A stirring audio program may be included to enhance the experience of the casual visitor or to inspire players before game day.

### **Interpretive Highlights**

- Exterior sandlot football sculptures take a form similar to those in Illini Park and along the pedestrian spine.
- Wayfinding and various interpretive elements help connect the interpretation along Fourth Street to the southern portion of the campus.
- One of these major interpretive elements is a bronze sculpture of a couple of kids, one standing on the others shoulders, and spying through the fence into the outdoor practice facility.
- A stirring audio program combines music, radio calls of milestone moments, and historical speeches to fire teams up before games and to excite recruits. The program may or may not be programmed with projected imagery and/or themed lighting.

## **Irwin Academic Center**

### **Main Message**

Illini student athletes excel in the classroom as well as in the competition venue. The University of Illinois is committed to the total individual. Illini graduates leave campus prepared to pursue professional careers and take leadership roles in their community.

### **Interpretive Strategy**

A sculpture outside Irwin Academic Center, dedicated to Academic All-Americans, suggests students pouring over books. Inside, the lobby includes shallow wall-mounted display cases, graphics, and imagery that highlight academic opportunities available to Illini student athletes and feature successful graduates. A computer lookup system lists Illini Academic All-Americans and Scholar Athletes, and offers visitors an opportunity to track the accomplishments of Illini letter-winners after graduation.





# SUMMARY REPORT

*The new University of Illinois Athletic campus will become a unique expression of the Fighting Illini spirit, inviting all visitors to enjoy and become a part of the Illinois tradition.*

## PRELIMINARY DEVELOPMENT BUDGET

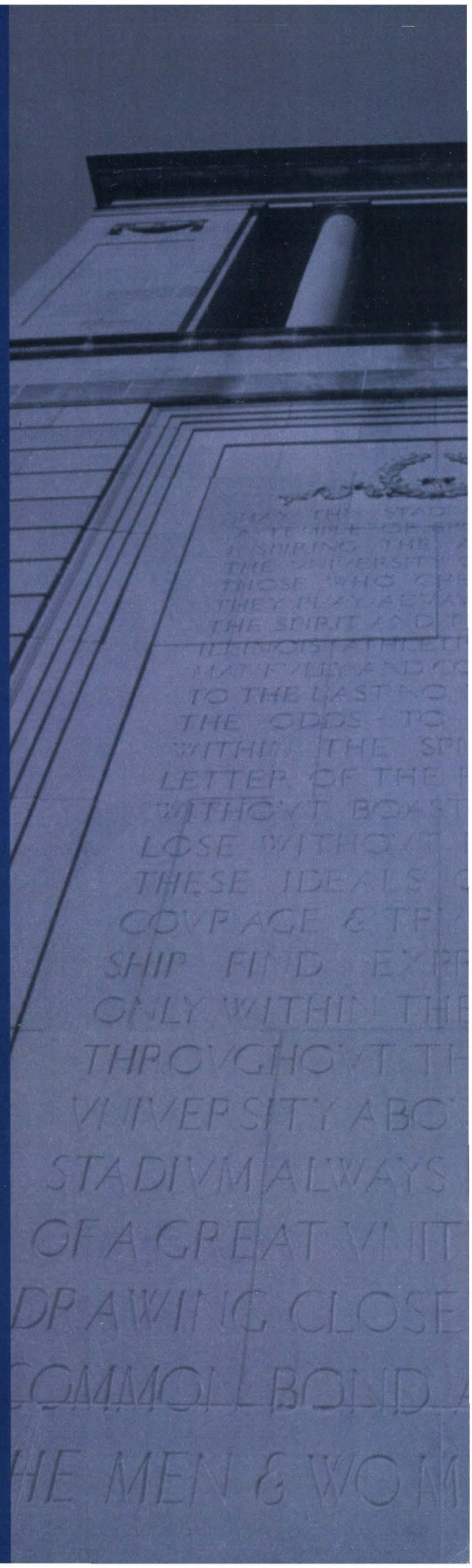

## Preliminary Estimate of Development Costs

Estimated costs for the planned interpretive elements, site development and building construction associated with each of the venues below are provided in current (2001) dollars. An allowance for the Owner's non-construction cost items is included in each line item leading to a total project budget.

### Multi-Sport Complex

Interpretive	
A to Z Gallery .....	1,456,000
Orientation Experience .....	2,800,000
Computer Look-Up System .....	140,000
Theming for Gift Shop .....	70,000
Theming for Lobby (With Athlete of the Year Sculptural Element) .....	350,000
Changing Gallery .....	210,000
Baseball Clubhouse .....	35,000
Theming for Food Cafe .....	70,000
Athlete of Year Sculptural Event .....	250,000
Large Scale Video Projection System in Arena .....	500,000
	CATEGORY TOTAL .....
	5,881,000
Site Development	
Walks .....	180,000
Drives .....	240,000
Kirby Pull-Off .....	240,000
Utilities .....	60,000
Detention .....	120,000
Landscape and Irrigation .....	120,000
	CATEGORY TOTAL .....
	960,000
Architecture	
Multi-Sport Practice Facility/Competition Arena (Includes Visitor's Center) .....	29,600,000
Service Drive and Loading Dock .....	335,000
	CATEGORY TOTAL .....
	29,935,000
	VENUE TOTAL .....
	36,776,000

### Illini Park

Interpretive	
Main Gateway Elements .....	250,000
Orientation Kiosk .....	150,000
LED Screen on Multi-Sport Building .....	700,000
Focus Sport Sculpture .....	700,000
Flags and Pennants .....	210,000
Whirligigs .....	168,000
Life Cast Figures and Kid's Plaza Elements .....	420,000
Sculptural Benches .....	58,000
	CATEGORY TOTAL .....
	2,656,000
Site Development	
Amphitheater Seating .....	240,000
Gateway .....	1,200,000
Exterior Plaza .....	1,200,000
Water Feature .....	1,200,000
Exterior Lighting and PA/Sound System .....	720,000
Landscape and Irrigation .....	360,000
	CATEGORY TOTAL .....
	4,920,000
Architecture	
None .....	0
	CATEGORY TOTAL .....
	0
	VENUE TOTAL .....
	7,576,000





## Bielfeldt Athletic Administration Building

Interpretive	
Themed Social Space (Hall of Fame Room)	3,115,000
AV Show and Equipment	
Cases	
Ceiling Treatment	
Window Treatment	
Main Hallway Temporary Exhibits and Up-Coming Events Announcements	196,000
Donor Recognition System	210,000
Big Ten Medal of Honor Sculpture on Terrace	70,000
Touch Screen Look-Up Kiosks	70,000
	CATEGORY TOTAL 3,661,000
Site Development	
Outdoor Terrace	675,000
Visitor Parking at Existing Drop-Off	60,000
Expanded Parking and New Drop-Off	300,000
Exterior Lighting	135,000
Landscape and Irrigation	360,000
	CATEGORY TOTAL 1,530,000
Architecture	
Interior Remodeling Support for Interpretive Elements	
Themed Social Space (Hall of Fame Room)	123,000
Entry Foyer/Corridor	46,000
	CATEGORY TOTAL 169,000
	VENUE TOTAL 5,360,000

## Ubben/Bielfeldt Courtyard and Pedestrian Spine

Interpretive	
Ubben/Bielfeldt Courtyard	
Entry Portal (Ubben and Multi-Sport)	420,000
Whirligig Garden Interpretation	168,000
Interpretive Challenge Elements	50,000
Life Cast Figure Groups (Kid's Plaza) (3 groups: Basketball, Baseball and Track)	300,000
Pedestrian Spine	
Entry Portal	210,000
Interpretive Nodes, Video Binoculars, Benches	280,000
Interpretive Challenge Elements	50,000
	CATEGORY TOTAL 1,478,000
Site Development	
Ubben/Bielfeldt Courtyard	
Special Paving and Walks	450,000
Seatwalls	120,000
Exterior Lighting	120,000
Landscape and Irrigation	240,000
Pedestrian Spine	
Seat Walls/Nodes	120,000
Rehab Lighting	36,000
Special Paving and Walks	180,000
Landscape and Irrigation	96,000
	CATEGORY TOTAL 1,362,000
Architecture	
None	0
	CATEGORY TOTAL 0
	VENUE TOTAL 2,840,000

## Atkins Tennis Center

Interpretive	
Entry Portal .....	210,000
Intepretive Nodes, Video Binoculars, Benches .....	140,000
Banners .....	20,000
Touch Screen Look-Up Kiosk .....	35,000
Interior Walkway Graphic Enclosure .....	105,000
	CATEGORY TOTAL .....
	510,000
Site Development	
Tennis Courts with Lighting .....	1,200,000
Special Paving and Walks .....	300,000
Utilities .....	60,000
Exterior Lighting .....	72,000
Landscape and Irrigation .....	192,000
	CATEGORY TOTAL .....
	1,824,000
Architecture	
Interior Remodeling Support for Interpretive Elements	
First Floor Corridor .....	33,000
New West Entry - "Crows Next" (Includes Adjacent 2nd Flr Interior Remodeling) .....	235,000
Indoor Courts Expansion (2) .....	2,145,000
Outdoor Stadium Addition .....	4,000,000
	CATEGORY TOTAL .....
	6,413,000
	VENUE TOTAL .....
	8,747,000

## East Athletic Campus Entry

Interpretive	
Flags, Banners and Whirligigs .....	350,000
Entry Portal (Tennis) .....	210,000
Lifecast Figure Groups (Kid's Plaza) - 2 groups: Softball and Tennis .....	150,000
Bas Relief Wall Panels .....	500,000
	CATEGORY TOTAL .....
	1,210,000
Site Development	
Entry Drive and Drop-Off .....	660,000
Parking .....	900,000
Exterior Lighting .....	105,600
Landscape and Irrigation .....	360,000
	CATEGORY TOTAL .....
	2,025,600
Architecture	
East Entry Masonry Screen Walls .....	230,000
	CATEGORY TOTAL .....
	230,000
	VENUE TOTAL .....
	3,465,600

## Track/Soccer Courtyard and Field

Interpretive	
Track/Soccer Courtyard	
Whirligigs .....	98,000
Life Cast Figure Groups (Kid's Plaza) 2 groups: Soccer and Track and Field .....	147,000
Track/Soccer Field	
Entry Portal (2) .....	420,000
Interior Interpretive Panels .....	50,000
	CATEGORY TOTAL .....
	715,000
Site Development	
Special Paving and Walks .....	150,000
Screen Walls .....	180,000
Exterior Lighting .....	72,000
Landscape and Irrigation .....	192,000
	CATEGORY TOTAL .....
	594,000
Architecture	
Track/Soccer Field	
East Stadium Structure - 3000 Seats w/ Concessions/Restrooms/Storage/Changing/Medical ..	2,900,000
West Bleachers - 1000 Seats .....	200,000
	CATEGORY TOTAL .....
	3,100,000
	VENUE TOTAL .....
	4,409,000





## Ubben Basketball Practice Facility

Interpretive	
Corridor Wall Murals .....	98,000
Large Practice Gym Images .....	50,000
North Entry and Stairwell Images, Banners, Sculpture .....	70,000
Touch Screen Look-Up Kiosk .....	35,000
CATEGORY TOTAL .....	253,000
Site Development	
Expanded Parking .....	300,000
Exterior Lighting .....	69,600
Landscape and Irrigation .....	288,000
CATEGORY TOTAL .....	657,600
Architecture	
Interior Remodeling Support for Interpretive Elements	
North Entry/Lobby (Two-Story) .....	32,000
First Floor Corridor at Player's Facilities .....	22,000
Second Floor Balconies .....	36,000
Ubben Building Expansion .....	2,400,000
CATEGORY TOTAL .....	2,490,000
VENUE TOTAL .....	3,400,600

## Illinois Field (Baseball)

Interpretive	
Entry Portal .....	210,000
Interior Interpretive Panels .....	50,000
CATEGORY TOTAL .....	260,000
Site Development	
Special Paving and Walks .....	75,000
Exterior Lighting .....	36,000
Landscape and Irrigation .....	192,000
Practice Infield .....	90,000
CATEGORY TOTAL .....	393,000
Architecture	
Spectator Seating Expansion (1500) .....	520,000
Remodel Existing Baseball Building .....	215,000
CATEGORY TOTAL .....	735,000
VENUE TOTAL .....	1,388,000

## Eichelberger Field (Softball)

Interpretive	
Entry Portal .....	210,000
Interior Interpretive Panels .....	50,000
CATEGORY TOTAL .....	260,000
Site Development	
Special Paving .....	75,000
Exterior Lighting .....	36,000
Utilities .....	60,000
Landscape and Irrigation .....	192,000
Practice Infield .....	60,000
CATEGORY TOTAL .....	423,000
Architecture	
Venue Service Building(s) w/ Press Box, Concessions, Restrooms, Changing & Medical .....	390,000
CATEGORY TOTAL .....	390,000
VENUE TOTAL .....	1,073,000

## Memorial Stadium

Interpretive	
West Lawn Elements .....	210,000
Stair Tower Elements (4) with Soundscapes) .....	1,400,000
Concourse "Great Halls" Elements (2) .....	560,000
Touch Screen Look-Up Kiosk .....	70,000
Colonnade Interpretation .....	50,000
East Walkway Terminus Elements .....	175,000
West Walkway Terminus Elements .....	175,000
Zuppke Memorial Interpretive Elements .....	200,000
	CATEGORY TOTAL .....
	2,840,000
Site Development	
West Side Exterior Walk .....	300,000
East Side Exterior Walk .....	300,000
Entry Courtyards .....	3,600,000
Turf Renovation .....	900,000
	CATEGORY TOTAL .....
	5,100,000
Architecture	
Interior Remodeling Support for Interpretive Elements	
Great Halls (2) .....	100,000
Stair Towers (4) .....	120,000
Colonnade .....	10,000
Exterior Remodeling support for Interpretive Elements	
East and West Walkways .....	20,000
Press/Sky Box Addition .....	25,000,000
South Stands (Horseshoe) Replacement .....	25,000,000
Irwin Football Complex Expansion/Remodeling .....	3,000,000
North End Zone Project .....	4,000,000
	CATEGORY TOTAL .....
	57,250,000
	VENUE TOTAL .....
	65,190,000

## Irwin Football Practice Facility

Interpretive	
North Side Entry Portal and Lifecast Figures Plaza (Sandlot Football, Kids Peeking in Fence) .....	250,000
Interior Murals .....	160,000
Soundscape .....	70,000
	CATEGORY TOTAL .....
	480,000
Site Development	
Special Paving and Walks .....	75,000
Exterior Lighting .....	36,000
Landscape and Irrigation .....	192,000
	CATEGORY TOTAL .....
	303,000
Architecture	
Interior Remodeling Support for Interpretive Elements	
Entry Lobby and Practice Area .....	32,000
	CATEGORY TOTAL .....
	32,000
	VENUE TOTAL .....
	815,000

## Assembly Hall

Interpretive	
Theme Sculptural Elements and Portals .....	840,000
Whirligig Garden .....	210,000
Interior Interpretive Elements .....	105,000
Touchscreen Look-Up Kiosk .....	70,000
	CATEGORY TOTAL .....
	1,225,000
Site Development	
Special Paving and Walks .....	300,000
Exterior Lighting .....	72,000
Landscape and Irrigation .....	384,000
	CATEGORY TOTAL .....
	756,000
Architecture	
Interior Remodeling Support for Interpretive Elements	
Entry Lobby .....	16,000
	CATEGORY TOTAL .....
	16,000
	VENUE TOTAL .....
	1,997,000





## IMPE Pool

Interpretive	
Entry Portal or Kiosk .....	210,000
Life Cast Figure Group (Kid's Plaza) .....	80,000
CATEGORY TOTAL .....	290,000
Site Development	
Exterior Lighting .....	36,000
Landscape and Irrigation .....	192,000
CATEGORY TOTAL .....	228,000
Architecture	
None .....	0
CATEGORY TOTAL .....	0
VENUE TOTAL .....	518,000

## Huff Hall

Interpretive	
Entry Portal or Kiosk .....	140,000
Life Cast Figure Group (Kid's Plaza) .....	80,000
Minimal Interior Elements .....	30,000
CATEGORY TOTAL .....	250,000
Site Development	
Exterior Lighting .....	36,000
Landscape and Irrigation .....	192,000
CATEGORY TOTAL .....	228,000
Architecture	
None .....	0
CATEGORY TOTAL .....	0
VENUE TOTAL .....	478,000

## Armory

Interpretive	
Entry Portals or Kiosks (3 or 4) .....	280,000
Life Cast Figure Group (Kid's Plaza) .....	80,000
Minimal Interior Elements .....	50,000
CATEGORY TOTAL .....	410,000
Site Development	
Exterior Lighting .....	36,000
Landscape and Irrigation .....	192,000
CATEGORY TOTAL .....	228,000
Architecture	
None .....	0
CATEGORY TOTAL .....	0
VENUE TOTAL .....	638,000

## Irwin Academic Center

Interpretive	
Exterior Interpretation .....	42,000
Life Cast Figure Group (Kid's Plaza) .....	42,000
Touch Screen Look-Up Kiosk .....	35,000
Minimal Interior Interpretation .....	35,000
CATEGORY TOTAL .....	154,000
Site Development	
None .....	0
CATEGORY TOTAL .....	0
Architecture	
None .....	0
CATEGORY TOTAL .....	0
VENUE TOTAL .....	154,000

## Gateways

Interpretive		
Main Gateway (3 Corners)		
Interpretive Elements .....	250,000	
Sculptural Elements .....	375,000	
Benches .....	125,000	
Secondary Gateway (4)		
Interpretive Elements and Benches .....	270,000	
Sculptural Elements .....	675,000	
Goodwin Improvements		
Whirligigs, Flags and Banners .....	200,000	
	CATEGORY TOTAL .....	1,895,000
Site Development		
Fourth/Armory .....	360,000	
Fourth/Gregory .....	480,000	
Fourth/Peabody .....	480,000	
Kirby/Oak .....	360,000	
Florida/Goodwin .....	360,000	
Fourth/St. Mary's .....	360,000	
	CATEGORY TOTAL .....	2,400,000
Architecture		
None .....	0	
	CATEGORY TOTAL .....	0
	VENUE TOTAL .....	4,295,000

## Streetscapes

Interpretive		
Fourth Street Streetscape from Armory Ave. to St. Mary's Road		
Interpretive Nodes, Including Westside Walk with 50 yardline Interpretive (Video Binoculars) .....	280,000	
Whirligigs, Flags and Banners .....	270,000	
Sandlot Football, Kids Peeking in Fence .....	200,000	
	CATEGORY TOTAL .....	750,000
Site Development		
Fourth Street Historic Corridor (Pedestrian Oriented)		
Seat Walls/Nodes with Special Paving .....	120,000	
Historic Lighting and Banners .....	150,000	
Landscape and Irrigation .....	192,000	
Kirby/Florida (Vehicular Oriented)		
Vehicular Lighting and Banners .....	168,000	
Landscape and Irrigation .....	192,000	
Goodwin and St. Mary's		
Vehicular Lighting and Banners .....	84,000	
Landscape and Irrigation .....	192,000	
	CATEGORY TOTAL .....	1,098,000
Architecture		
None .....	0	
	CATEGORY TOTAL .....	0
	VENUE TOTAL .....	1,848,000



## General

### Interpretive

Wayfinding System	
Directories .....	85,000
Directional Signage .....	210,000
Regulatory Signage .....	50,000
Icons at Venue Entry Points (Side Streets) .....	60,000
Future Interpretive at Hotel and Conference Facility .....	TBD
Program and Content Development for Video Look-Up System .....	350,000
CATEGORY TOTAL .....	755,000

### Site Development

Lawn Parking and Access .....	180,000
Jogging Paths .....	302,400
Landscape and Irrigation .....	1,200,000
Future Venue Site Parking and Access .....	300,000
CATEGORY TOTAL .....	1,982,400

### Architecture

None .....	0
CATEGORY TOTAL .....	0

VENUE TOTAL ..... 2,737,400

TOTAL ALL INTERPRETIVE ..... 25,933,000

TOTAL ALL SITE DEVELOPMENT ..... 27,012,600

TOTAL ALL ARCHITECTURE ..... 100,760,000

**TOTAL ALL VENUES ..... 153,705,600**

